

Product Overview



Movex
Blueline













Sprockets



Movex[®]
OFFICIAL UK PARTNER



Belt sprockets

7870  Pag 40	7870  Pag 40	590  Pag 41	590  Pag 41	7510-7520  Pag 42	7510-7520  Pag 42
7510-7520  Pag 43	7510-7520  Pag 43	7010  Pag 44	7010  Pag 44	ZERO CONTACT  Pag 45	ZERO CONTACT PRO  Pag 45

This catalog contains only a limited selection of all the products available at Movex S.p.A.
 For a complete overview, please visit our website or contact your sales representative.

Material
 Info:

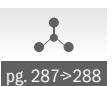

pg. 287 > 288

Materiale / Material / Materialien:

Poliammide/Polyamide/Polyamid Viti: Acciaio inox/Screws: Stainless steel/Schrauben: Edelstahl Dadi: ferro zincato/Nuts: zinc plated steel/Mutter: verzinkter Stahl Resina acetalica/Acetal resin/Azetal

7870 Ruota traino divisa, fresata Split drive sprocket, machined / geteiltes Antriebskettenrad, gefräst

Article-Nr.	Z-	Bore	PD	OD	S
PA Natural					
159936E	16**	20	40,5	40,2	17,25
160101E	18**	25	46,5	47,3	20,2
160111E		20*20	□		
159896E	20**	25	51,5	51,5	22,3
160201E	24**	25	61,8	62,6	27,9
160206E		25*25	□		
160301	36	25	92,6	93,5	43,3
160302		30			
160303		35			
160304		40			
160306		25*25	□		
160307		30*30	□		
160308		40*40	□		

**Drive sprockets z-16, z-18, z-20 and z-24 are supplied non-split

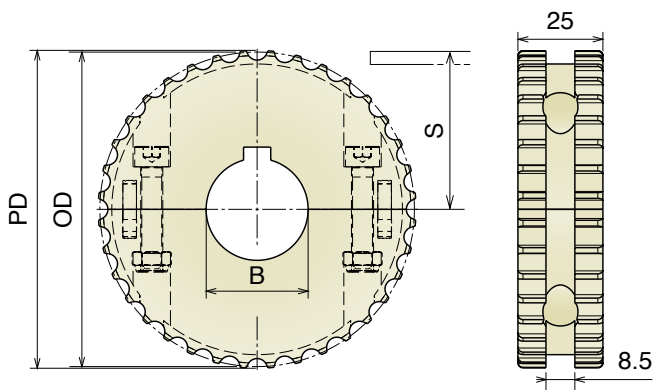

Ruota traino, stampata Drive sprocket, molded / Antriebskettenrad, gespritzt

Article-Nr.	Z-	Bore	PD	OD	S
POM Natural					
159780	16	15	40,5	40,2	17,25

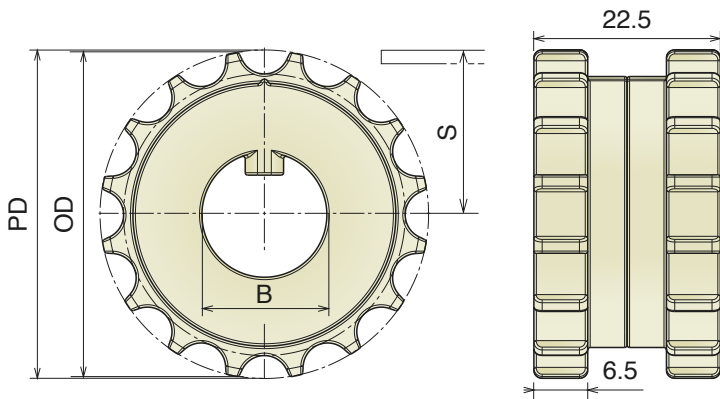
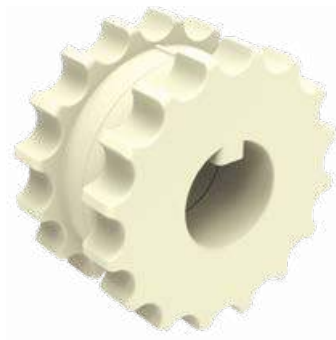

590 Ruota traino divisa, fresata

Split drive sprocket, machined / geteiltes Antriebskettenrad, gefräst

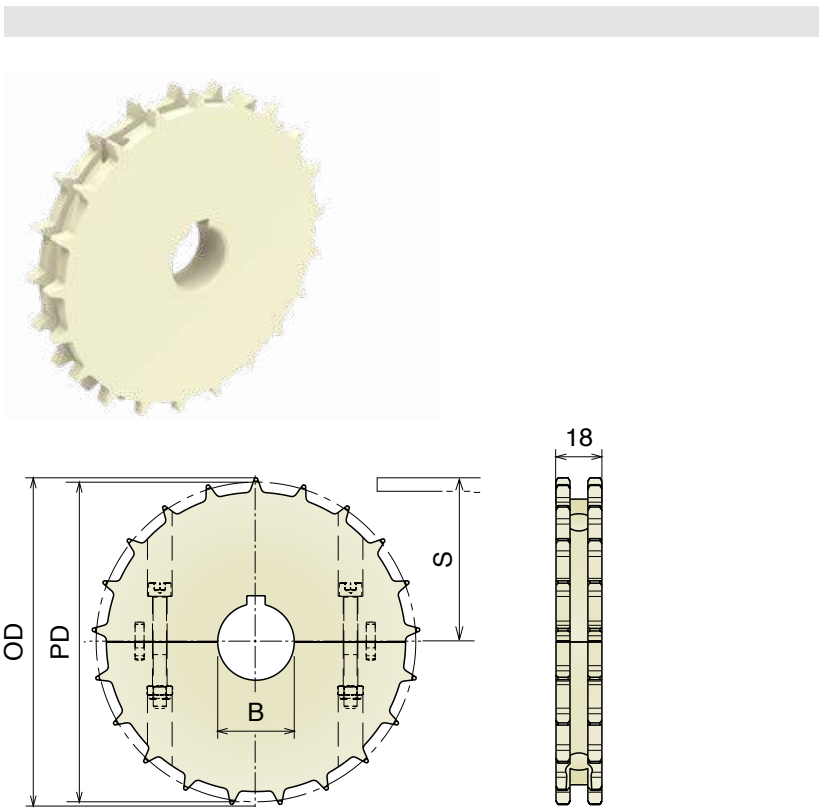

Article-Nr.	Z-	Bore	PD	OD	S
PA Natural					
151101	17	25	100,7	103,4	46,0
151102		30			
151103		35			
151104		40			
151106		25* 25			
151107		30* 30			
151108		40* 40			
151201	21	25	126,0	128,7	58,65
151202		30			
151203		35			
151204		40			
151206		25* 25			
151207		30* 30			
151208		40* 40			
151301	24	25	142,9	145,6	67,1
151302		30			
151303		35			
151304		40			
151306		25* 25			
151307		30* 30			
151308		40* 40			
151401	25	25	149,0	151,7	70,15
151402		30			
151403		35			
151404		40			
151406		25* 25			
151407		30* 30			
151408		40* 40			

Ruota rinvio divisa, fresata

Split idler sprocket, machined / geteiltes Umlenrad, gefräst

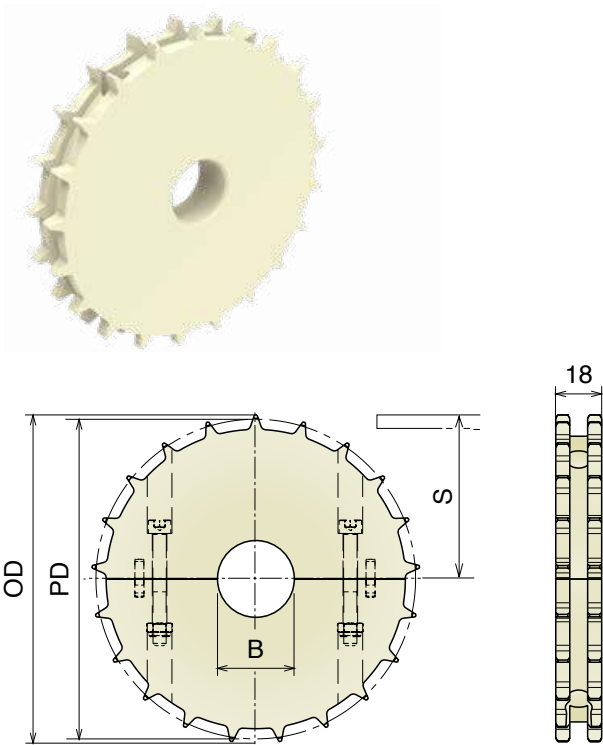

Article-Nr.	Z-	Bore	PD	OD	S
PA Natural					
151150	17	18*	100,7	103,4	46,0
151151		25			
151152		30			
151153		35			
151154		40			
151250	21	18*	126,0	128,7	58,65
151251		25			
151252		30			
151253		35			
151254		40			
151350	24	18*	142,9	145,6	67,1
151351		25			
151352		30			
151353		35			
151354		40			
151450	25	18*	149,0	151,7	70,15
151451		25			
151452		30			
151453		35			
151454		40			

*Plain Bore

7510-7520

Ruota traino divisa, fresata

Split drive sprocket, machined / geteiltes Antriebskettenrad, gefräst

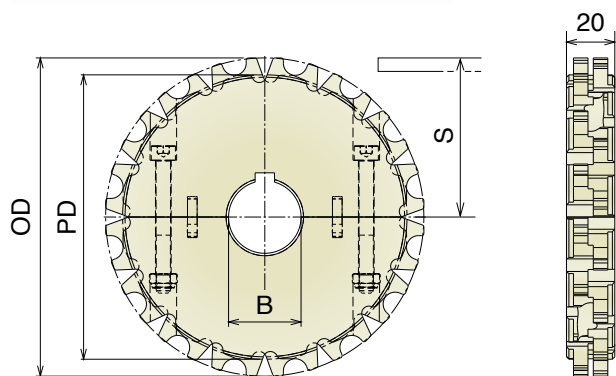
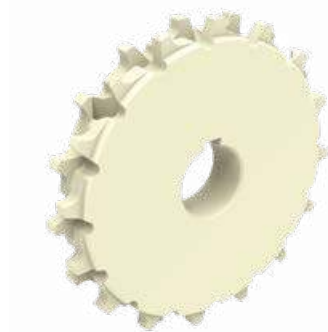

Article-Nr.	Z-	Bore	PD	OD	S
PA Natural					
242302	12	30	98,1	99,7	43,5
242402	15	30	122,2	124,2	56
242404		40	122,2	124,2	56
242408		40*40	122,2	124,2	56
242502	16	30	130,2	132,4	60
242504		40	130,2	132,4	60
242508		40*40	130,2	132,4	60
242510		60*60	130,2	132,4	60
242602	18	30	146,3	148,6	68
242604		40	146,3	148,6	68
242608		40*40	146,3	148,6	68
242610		60*60	146,3	148,6	68
242702	20	30	162,4	165	76
242704		40	162,4	165	76
242708		40*40	162,4	165	76
242710		60*60	162,4	165	76

Ruota rinvio divisa, fresata

Split idler sprocket, machined / geteiltes Umlenrad, gefräst

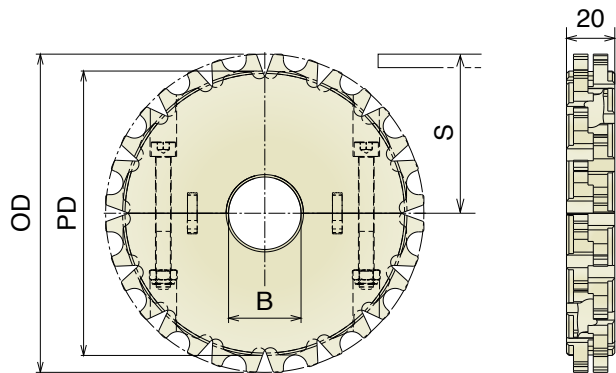

Article-Nr.	Z-	Bore	PD	OD	S
PA Natural					
242352	12	30	98,1	99,7	43,5
242452	15	30	122,2	124,2	56
242454		40	122,2	124,2	56
242552	16	30	130,2	132,4	60
242554		40	130,2	132,4	60
242652	18	30	146,3	148,6	68
242654		40	146,3	148,6	68
242752	20	30	162,4	165	76
242754		40	162,4	165	76

7510-7520

Ruota traino, stampata
Drive sprocket, molded / Antriebskettenrad, gespritzt

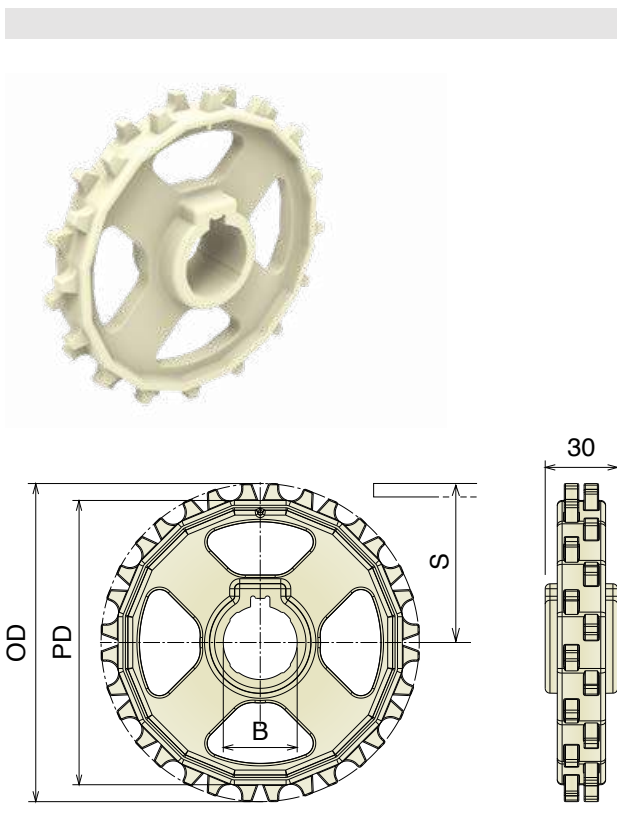

Article-Nr.		Z-	Bore	PD	OD	S
POM Natural	PA Natural					
240006	240006PA	7	25* 25	58,5	58,4	23,5
240102	240102PA	8	30	66,4	67,8	28,2
240106	240106PA		25* 25	66,4	67,8	28,2
240202	240202PA	10	30	82,2	83,3	35,6
240204	240204PA		40	82,2	83,3	35,6
240208	240208PA		40* 40	82,2	83,3	35,6
240301	240301PA	12	25	98,1	99,7	43,5
240302	240302PA		30	98,1	99,7	43,5
240304	240304PA		40	98,1	99,7	43,5
240308	240308PA		40* 40	98,1	99,7	43,5
240402	240402PA	15	30	122,2	124,2	56
240404	240404PA		40	122,2	124,2	56
240408	240408PA		40* 40	122,2	124,2	56
240410	240410PA		60* 60	122,2	124,2	56
240502	240502PA	16	30	130,2	132,4	60
240504	240504PA		40	130,2	132,4	60
240508	240508PA		40* 40	130,2	132,4	60
240510	240510PA		60* 60	130,2	132,4	60
240602	240602PA	18	30	146,3	148,6	68
240604	240604PA		40	146,3	148,6	68
240608	240608PA		40* 40	146,3	148,6	68
240610	240610PA		60* 60	146,3	148,6	68
240702	240702PA	20	30	162,4	165	76
240704	240704PA		40	162,4	165	76
240708	240708PA		40* 40	162,4	165	76
240710	240710PA		60* 60	162,4	165	76

Ruota rinvio, stampata
Idler sprocket, molded / Umlenkrad, gespritzt

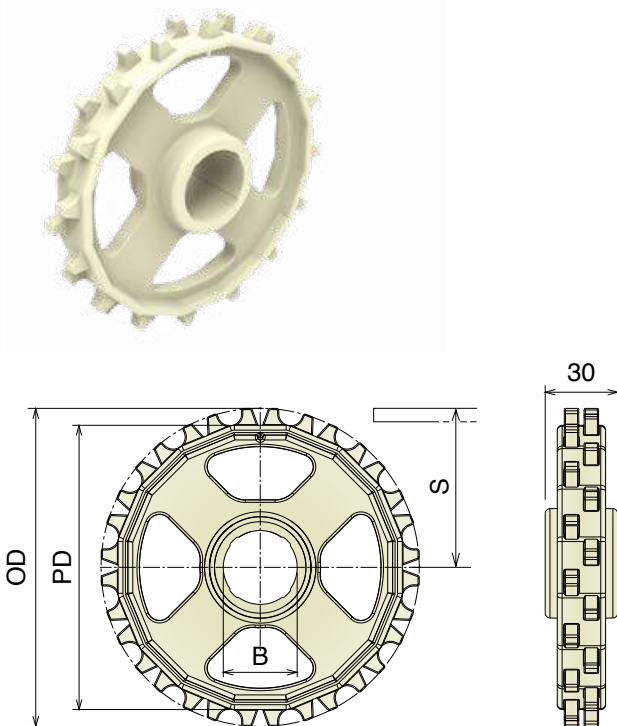

Article-Nr.		Z-	Bore	PD	OD	S
POM Natural	PA Natural					
240152	240152PA	8	30	66,4	67,8	28,2
240252	240252PA	10	30	82,2	83,3	35,6
240254	240254PA		40	82,2	83,3	35,6
240351	240351PA	12	25	98,1	99,7	43,5
240352	240352PA		30	98,1	99,7	43,5
240354	240354PA		40	98,1	99,7	43,5
240452	240452PA	15	30	122,2	124,2	56
240454	240454PA		40	122,2	124,2	56
240552	240552PA	16	30	130,2	132,4	60
240554	240554PA		40	130,2	132,4	60
240652	240652PA	18	30	146,3	148,6	68
240654	240654PA		40	146,3	148,6	68
240752	240752PA	20	30	162,4	165	76
240754	240754PA		40	162,4	165	76

Materiale / Material / Materialien:

Resina acetica/Acetal resin/Azetal Viti: Acciaio inox/Screws: Stainless steel/Schrauben: Edelstahl
 Dadi: Acciaio inox/Nuts: Stainless steel/Mutter: Edelstahl
 Poliammide/Polyamide/Polyamid Viti: Acciaio inox/Screws: Stainless steel/Schrauben: Edelstahl
 Dadi: ferro zincato/Nuts: zinc plated steel/Mutter: verzinkter Stahl

7010

Ruota traino divisa, fresata
 Split drive sprocket, machined / Antriebskettenrad, gefräst

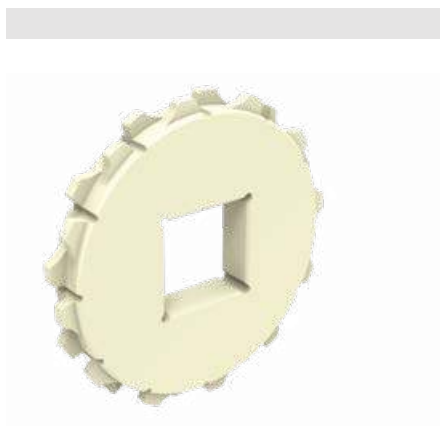

Article-Nr.	Z-	Bore		PD	OD	S
PA Natural						
243108	8	40*40	☒	132,7	126,6	57,8
243208	10	40*40	☒	164,4	159,7	74
243210		60*60	☒	164,4	159,7	74
243308	12	40*40	☒	196,3	192,4	90
243310		60*60	☒	196,3	192,4	90
243408	16	40*40	☒	260,4	257	122
243410		60*60	☒	260,4	257	122

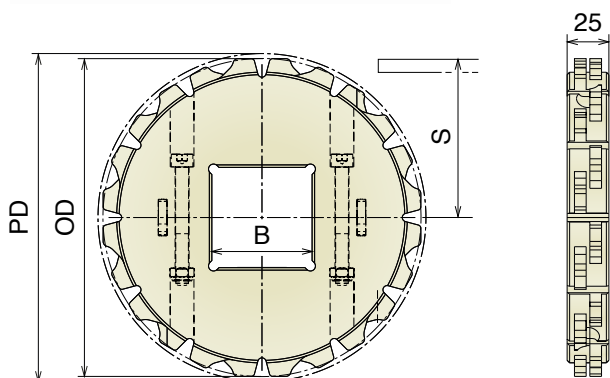

Ruota traino, stampata
 Drive sprocket, molded / Antriebskettenrad, gespritzt

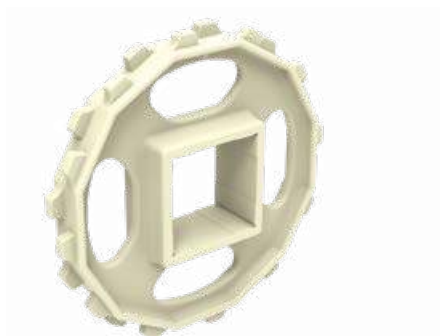

Article-Nr.		Z-	Bore		PD	OD	S
POM Natural	PA Natural						
241008	241008PA	6	40*40	☒	101,6	93,2	41,5
241108	241108PA	8	40*40	☒	132,7	126,6	57,8
241110	241110PA		60*60	☒	132,7	126,6	57,8
241208	241208PA	10	40*40	☒	164,4	159,7	74
241210	241210PA		60*60	☒	164,4	159,7	74
241308	241308PA	12	40*40	☒	196,3	192,4	90
241310	241310PA		60*60	☒	196,3	192,4	90
241408	241408PA	16	40*40	☒	260,4	257	122
241410	241410PA		60*60	☒	260,4	257	122

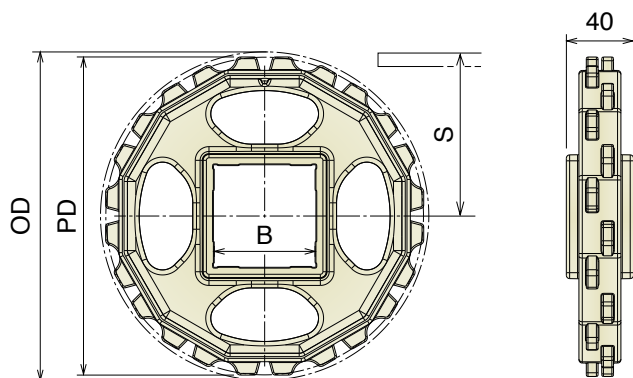

ZERO CONTACT

Ruota traino, fresata
 Drive sprocket, machined / Antriebskettenrad, gefräst

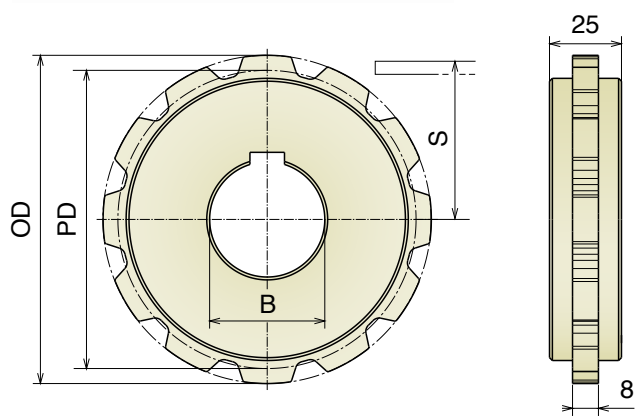

Article-Nr.	Z-	Bore	R _r +50	PD	OD	S
PA Natural						
162401	12	40	650	58,0	61,0	25,6
162402			750	66,0	69,0	29,9
162403			850	76,0	79,0	34,2
162404			950	84,0	86,0	38,5
162405			1050	94,0	97,0	42,8
162406			1150	102,0	104,0	47,1
162407			1250	112,0	114,0	51,4
162408			1350	119,0	122,0	55,7
162409			1450	130,0	132,0	60,0
162410			1550	137,0	140,0	64,3
162411			1650	145,0	148,0	68,6
162412			1750	154,0	157,0	72,9
162413			1850	163,0	166,0	77,2
162414			1950	171,0	174,0	81,5
162415			2050	180,0	183,0	85,8
162416			2150	189,0	192,0	90,1

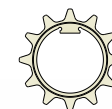
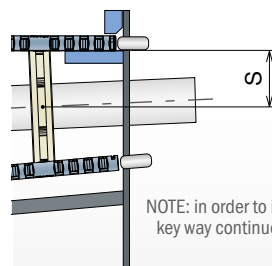

Smallest sprocket with integrated key valid only for code 162401

NOTE: in order to install the smallest sprockets a shaft key way continued to the end of the shaft is required.

ZERO CONTACT PRO

Ruota traino, fresata
 Drive sprocket, machined / Antriebskettenrad, gefräst

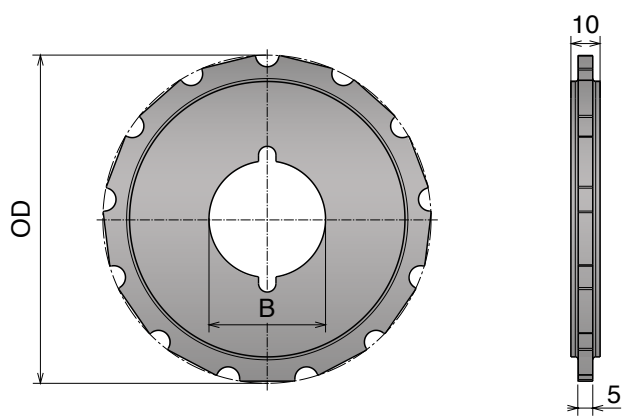

Article-Nr.	Z-	Bore	OD
PA Black			
163301	13	30	45,9
163302			52,0
163303		40	58,0
163304			64,1
163305			70,2
163306			76,2
163307			82,3
163308			88,3
163309			94,4
163310			100,5
163311			106,6
163312			112,6
163313			118,7
163314			124,7
163315			130,8
163316			136,9
163317			142,9



Movex
OFFICIAL UK PARTNER

Oadby Conveyors

Oadby Conveyors
68 Scudamore Road
Braunstone Frith Ind. Est.
Leicester
LE3 1UA

0116 232 4848
convteam@oadbyplastics.co.uk

Head Office

Oadby Plastics Ltd
68 Scudamore Road
Braunstone Frith Ind. Est.
Leicester
LE3 1UA

0116 232 1010
sales@oadbyplastics.co.uk

For further information and specification details please visit our comprehensive website. Due to a policy of continual product development, Oadby Conveyors reserves the right to alter any of the specifications given in the publication without prior notice. The specification must be checked with Oadby Conveyors prior to manufacture. For this reason no responsibility or liability for accuracy is accepted by Oadby Conveyors.

Company registration No. 03542957 | www.oadbyconveyors.co.uk



Certificate Number 8147
ISO 9001, ISO 14001