

Product Overview

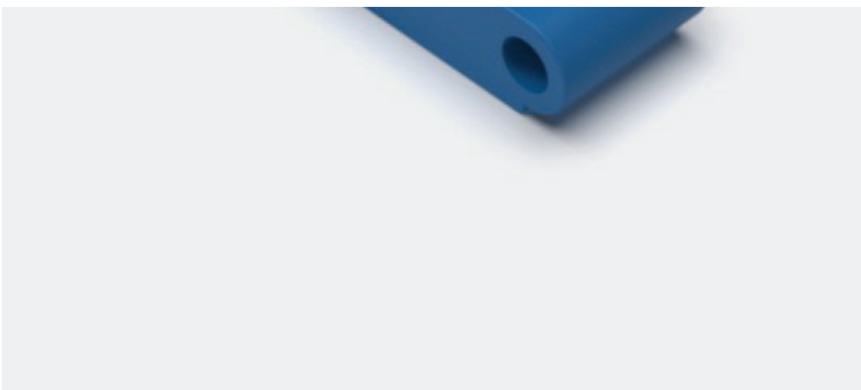

Movex
Blueline

Modular Belts

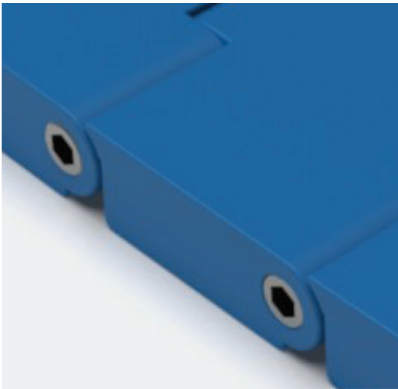

Movex[®]
OFFICIAL UK PARTNER

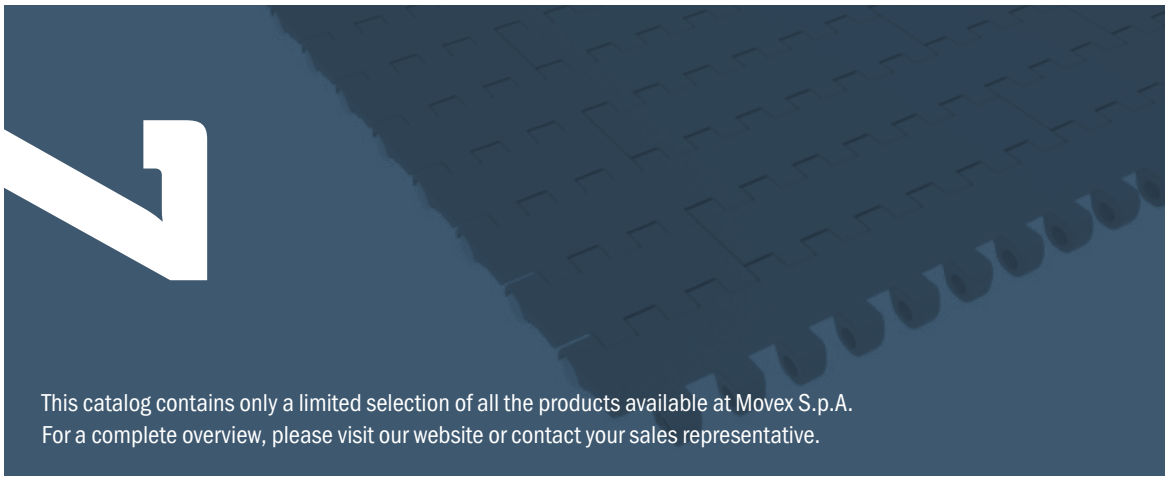

This catalog contains only a limited selection of all the products available at Movex S.p.A.
For a complete overview, please visit our website or contact your sales representative.

Modular belts

7870 Series

Pitch 8 mm

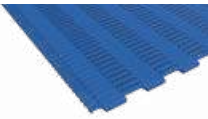

7870 FT
Page 9

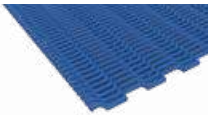

7870 FG
Page 10

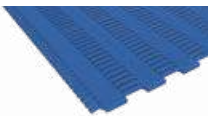

7870 DT
Page 11

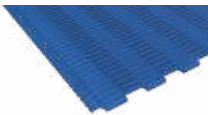

7870 CT
Page 12

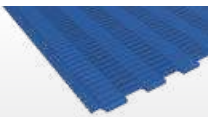

7870 NS
Page 13

590 Series

Pitch 19.05 mm



590 FT
Page 15



590 FG
Page 16



Accessories
Page 17

7510 Series

Pitch 25.4 mm (1 inch)



7510 FT
Page 19

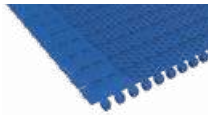

7510 NT
Page 20



7510 DT
Page 21



7510 MT
Page 22



Accessories
Page 23

7520 Series

Pitch 25.4 mm (1 inch)

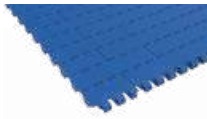

7520 FT
Page 25

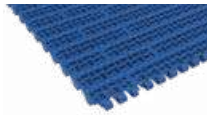

7520 FG
Page 26

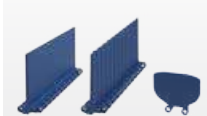

Accessories
Page 27

7010 Series

Pitch 50.8 mm (2 inch)

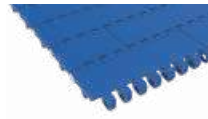

7010 FT
Page 29

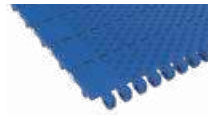

7010 CT
Page 30



7010 NT
Page 31



7010 PT
Page 32



Accessories
Page 33

Zero contact Series

Fixed radius curved belt



ZERO CONTACT
Page 35/36

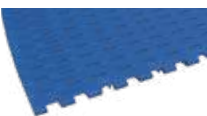

ZERO CONTACT PRO
Page 37/38

Material Info:



7870

Pitch 8 mm
H= 6 mm

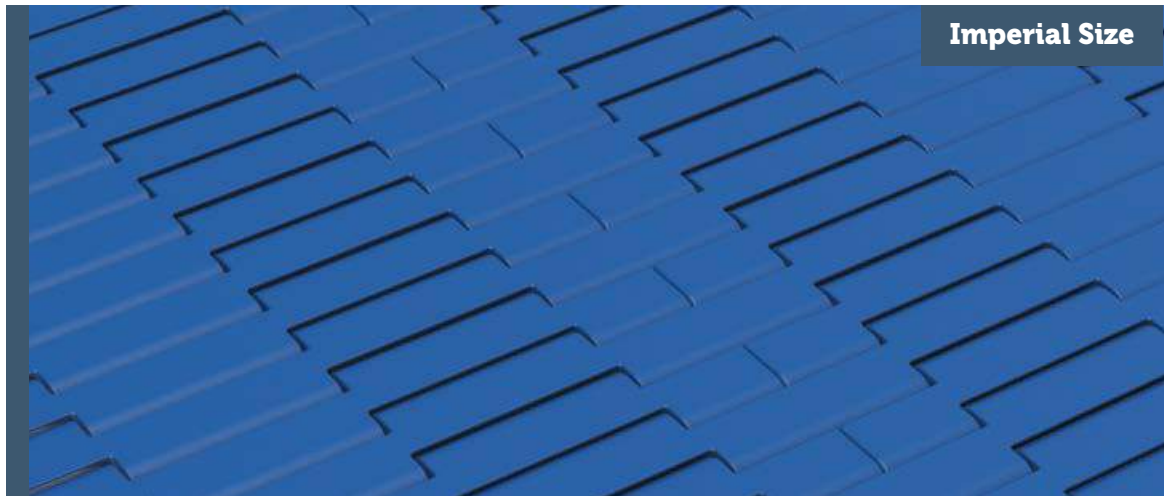

- 7870 FT
- 7870 FG
- 7870 DT
- 7870 CT
- 7870 NS

7870 FT *Flat Top* Tappeto Modulare 7870 FT, H=6 M=3" Modular Belt Series 7870 FT, H=6 M=3" / Modulare Mattenkette 7870 FT, H=6 M=3"

Backflex radius min.: 7.5 mm | Pin diameter: 3 mm

	Active transfer plate	
pg. 40	pg. 62>66	pg. 269>286

8 mm
PITCH



- Easier installation
- Quicker maintenance

Width* (inch)
0003
0006
0009
0012
0015
0018
0021
0024
0027
0030
0033
0036
0039
0042
0045
0048
0051
0054

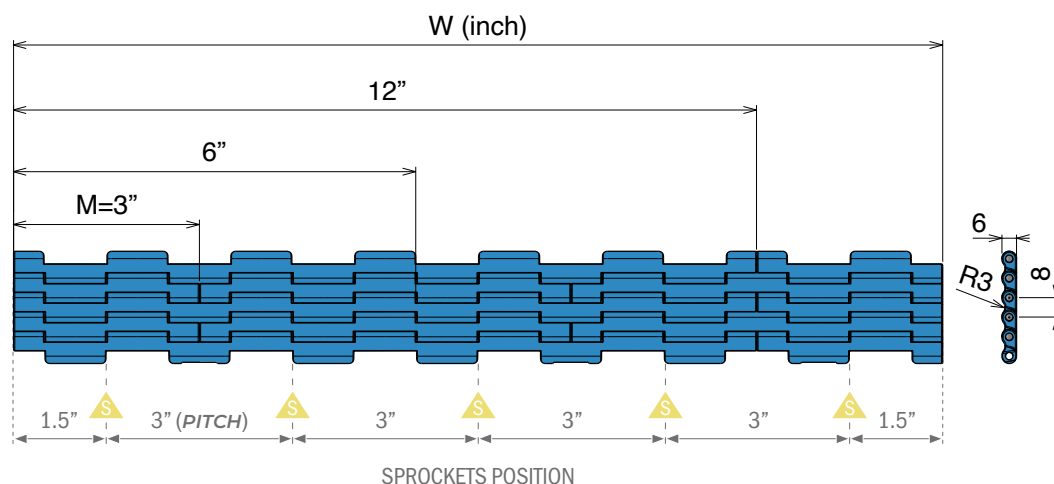

BELT MATERIAL	
POM - Acetal resin	
BELT COLORS	
RAL 5005	Cyan
White	LFA
PINS AVAILABLE	
PBT Pin	
Max w. load:	3000 N/m
Weight:	5.8 kg/m ²
Temp. range:	-40+80 °C

Nosebars

The best solution for a combination of short transfer and high performance:

Made from super-performance **BluLub®**, the smallest gaps are reached between the belts to assure a smooth and precise transfer.

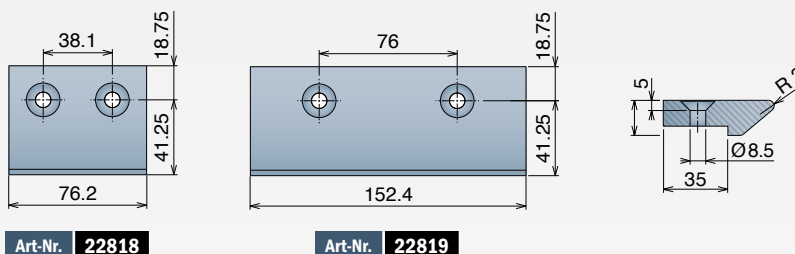

*Belts wider than standard are available with 3 inch increments.

The nominal tensile strength and the nominal width tolerance are valid for a temperature of 23°C (73 °F).

The actual width of the belt typically falls below the nominal value by 0.1% to 0.3%. For POM belts up to 750 mm (30") in width, the shrinkage ranges from -2 mm to 1 mm, and for those wider, from -0.35% to 0%.

Non-Standard belt widths are incremented by 25.4 mm (1"). The minimum width is 50.8 mm (2.0").

7870 FG Flush Grid Tappeto Modulare 7870 FG, H=6 M=3" / Modular Belt Series 7870 FG, H=6 M=3" / Modulare Mattenkette 7870 FG, H=6 M=3"

Backflex radius min.: 7.5 mm | Pin diameter: 3 mm



pg. 40

Active transfer plate

pg. 62>66



pg. 269>286

25.0%
OPEN SURFACE

8 mm
PITCH



- Easier installation
- Quicker maintenance

Width* (Inch)

- 0003
- 0006
- 0009
- 0012
- 0015
- 0018
- 0021
- 0024
- 0027
- 0030
- 0033
- 0036
- 0039
- 0042
- 0045
- 0048
- 0051
- 0054

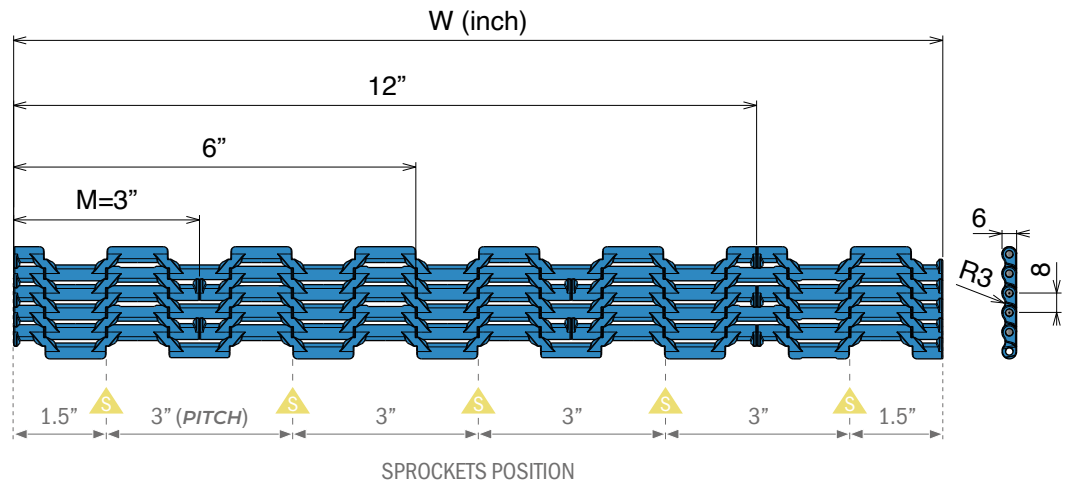

SPROCKETS POSITION

BELT MATERIAL

POM - Acetal resin

BELT COLORS

RAL 5005

Cyan

White

LFA

PINS AVAILABLE

PBT Pin

Max w. load: 3000 N/m
Weight: 5.1 kg/m²
Temp. range: -40+80 °C

Nosebars

The best solution for a combination of short transfer and high performance:

Made from super-performance **BluLub®**, the smallest gaps are reached between the belts to assure a smooth and precise transfer.

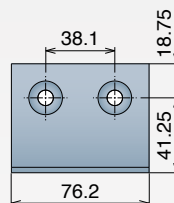

Art-Nr. **22818**

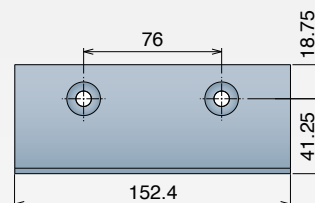

Art-Nr. **22819**

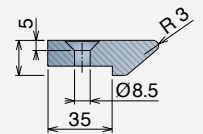

*Belts wider than standard are available with 3 inch increments.

The nominal tensile strength and the nominal width tolerance are valid for a temperature of 23°C (73 °F).

The actual width of the belt typically falls below the nominal value by 0.1% to 0.3%.

Non-Standard belt widths are incremented by 25.4 mm (1"). The minimum width is 50.8 mm (2.0").

7870 DT *Diamond Top* Tappeto Modulare 7870 DT, H=6 M=3" Modular Belt Series 7870 DT, H=6 M=3" / Modulare Mattenkette 7870 DT, H=6 M=3"

Backflex radius min.: 7.5 mm | Pin diameter: 3 mm

	Active transfer plate	
pg. 40	pg. 62>66	pg. 269>286

8 mm
PITCH



- Easier installation
- Quicker maintenance

Width* (inch)
0003
0006
0009
0012
0015
0018
0021
0024
0027
0030
0033
0036
0039
0042
0045
0048
0051
0054

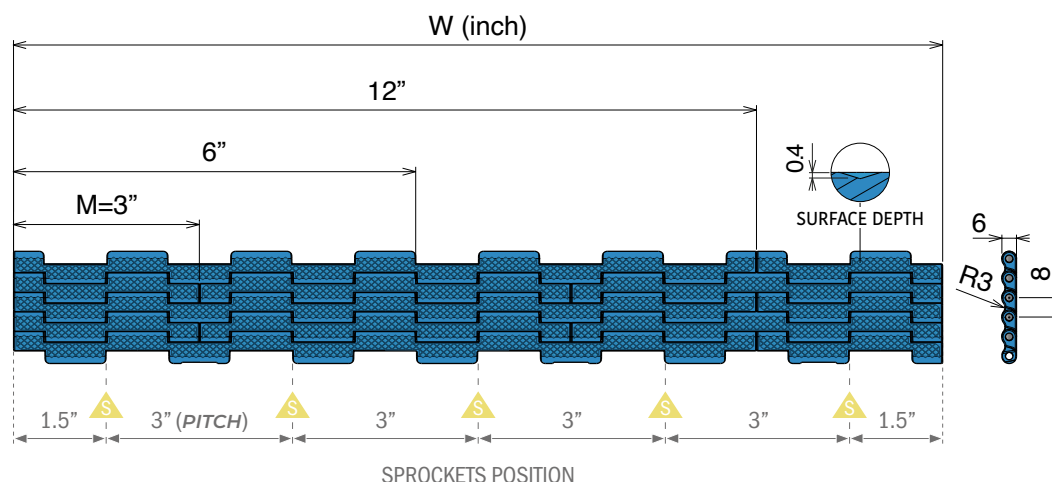

BELT MATERIAL	
POM - Acetal resin	
BELT COLORS	
RAL 5005	Cyan
White	LFA
PINS AVAILABLE	
PBT Pin	
Max w. load:	3000 N/m
Weight:	5.7 kg/m ²
Temp. range:	-40+80 °C

Nosebars

The best solution for a combination of short transfer and high performance:

Made from super-performance **BluLub®**, the smallest gaps are reached between the belts to assure a smooth and precise transfer.

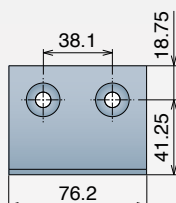

Art-Nr. **22818**

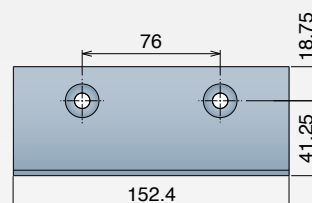

Art-Nr. **22819**

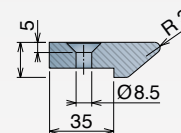

*Belts wider than standard are available with 3 inch increments.

The nominal tensile strength and the nominal width tolerance are valid for a temperature of 23°C (73 °F).

The actual width of the belt typically falls below the nominal value by 0.1% to 0.3%. For POM belts up to 750 mm (30") in width, the shrinkage ranges from -2 mm to 1 mm, and for those wider, from -0.35% to 0%.

Non-Standard belt widths are incremented by 25.4 mm (1"). The minimum width is 50.8 mm (2.0").

Imperial Size

7870 CT Cone Top Tappeto Modulare 7870 CT, H=6 M=3" / Modular Belt Series 7870 CT, H=6 M=3" / Modulare Mattenkette 7870 CT, H=6 M=3"

Backflex radius min.: 7.5 mm | Pin diameter: 3 mm

	Active transfer plate	
pg. 40	pg. 62>66	pg. 269>286

8 mm
PITCH



- Easier installation
- Quicker maintenance

Width* (Inch)
0003
0006
0009
0012
0015
0018
0021
0024
0027
0030
0033
0036
0039
0042
0045
0048
0051
0054

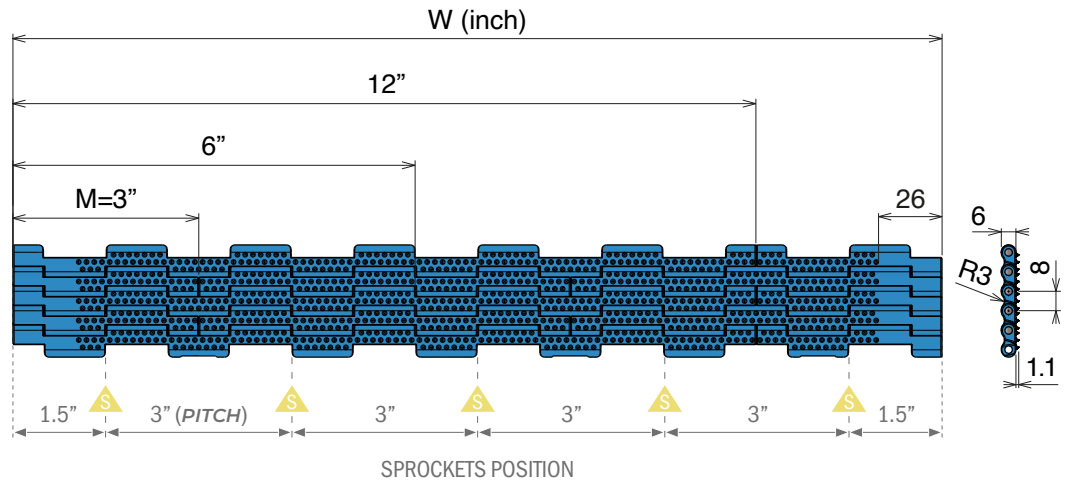

BELT MATERIAL	
POM - Acetal resin	
BELT COLORS	
RAL 5005	Cyan
White	LFA
PINS AVAILABLE	
PBT Pin	
Max w. load:	3000 N/m
Weight:	5.9 kg/m ²
Temp. range:	-40+80 °C

Nosebars

The best solution for a combination of short transfer and high performance:

Made from super-performance **BluLub®**, the smallest gaps are reached between the belts to assure a smooth and precise transfer.

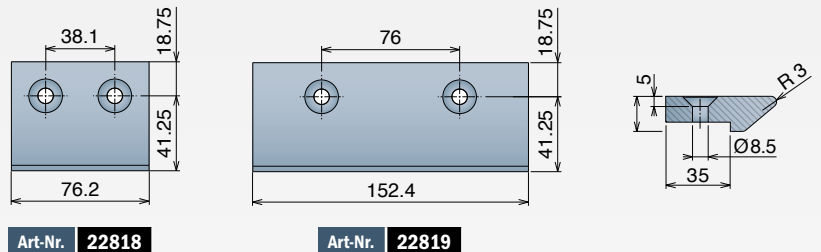

Art-Nr. **22818**

Art-Nr. **22819**

*Belts wider than standard are available with 3 inch increments.

The nominal tensile strength and the nominal width tolerance are valid for a temperature of 23°C (73 °F).

The actual width of the belt typically falls below the nominal value by 0.1% to 0.3%.

Non-Standard belt widths are incremented by 25.4 mm (1"). The minimum width is 50.8 mm (2.0").

Tappeti modulari / Modular belts / Mattenketten

7870 NS *Non Slip* Tappeto Modulare 7870 NS, H=6 M=3" Modular Belt Series 7870 NS, H=6 M=3" / Modulare Mattenkette 7870 NS, H=6 M=3"

Backflex radius min.: 7.5 mm | Pin diameter: 3 mm

	Active transfer plate	
pg. 40	pg. 62>66	pg. 269>286



8 mm
PITCH

Imperial Size



- Easier installation
- Quicker maintenance

Width* (inch)
0003
0006
0009
0012
0015
0018
0021
0024
0027
0030
0033
0036
0039
0042
0045
0048
0051
0054

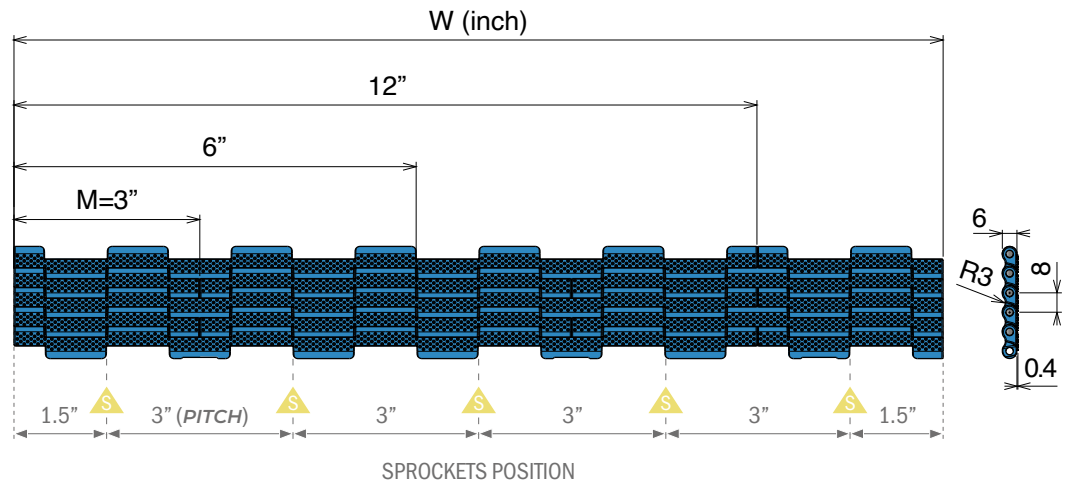

BELT MATERIAL	
POM - Acetal resin	
BELT COLORS	
RAL 5005	Cyan
White	LFA
PINS AVAILABLE	
PBT Pin	
Max w. load:	3000 N/m
Weight:	5.9 kg/m ²
Temp. range:	-40+80 °C

Nosebars

The best solution for a combination of short transfer and high performance:

Made from super-performance **BluLub®**, the smallest gaps are reached between the belts to assure a smooth and precise transfer.

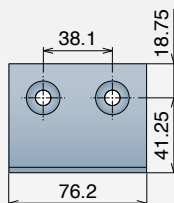

Art-Nr. **22818**

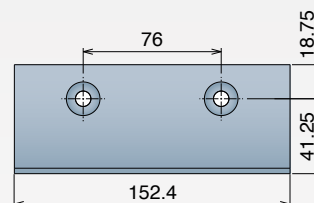

Art-Nr. **22819**

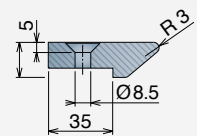

*Belts wider than standard are available with 3 inch increments.

The nominal tensile strength and the nominal width tolerance are valid for a temperature of 23°C (73 °F).

The actual width of the belt typically falls below the nominal value by 0.1% to 0.3%. For POM belts up to 750 mm (30") in width, the shrinkage ranges from -2 mm to 1 mm, and for those wider, from -0.35% to 0%.

Non-Standard belt widths are incremented by 25.4 mm (1"). The minimum width is 50.8 mm (2.0").

590

Pitch 19,05 mm
H= 8,7 mm

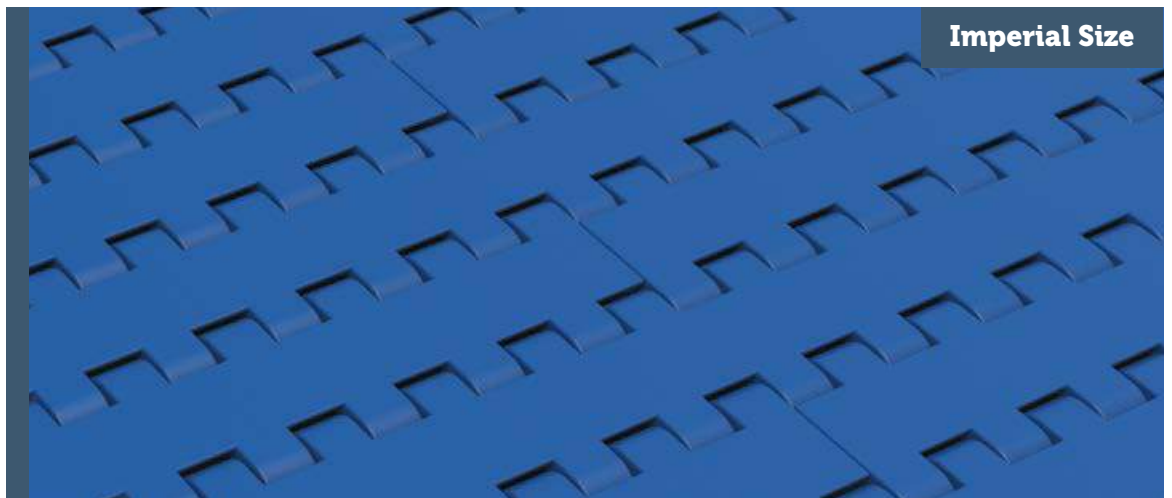

590 FT
590 FG
Accessories

590 FT Flat Top Tappeto Modulare 590 FT, H=8,7 M=3" Modular Belt Series 590 FT, H=8,7 M=3" / Modulare Mattenkette 590 FT, H=8,7 M=3"

Backflex radius min.: 25 mm | Pin diameter: 4.25 mm

	A Accessories	
pg. 41	pg. 17	pg. 269>286

19.05 mm
PITCH

Imperial Size

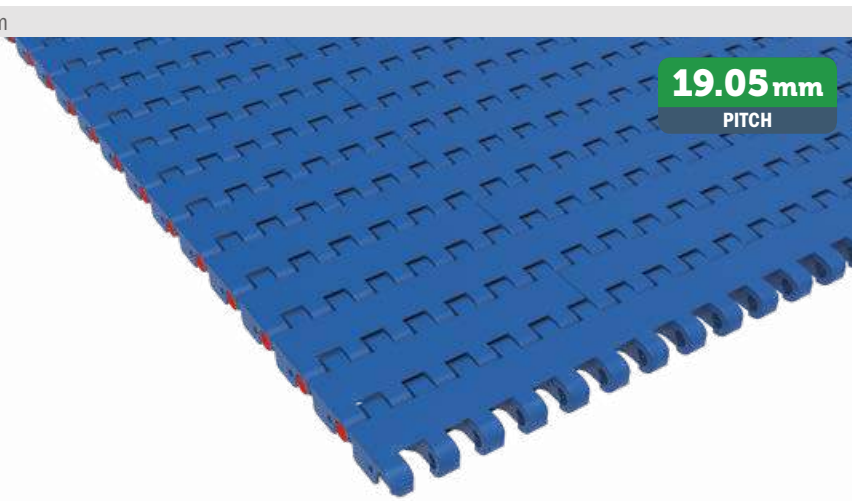

- Width* (inch)
- 0003
 - 0006
 - 0009
 - 0012
 - 0015
 - 0018
 - 0021
 - 0024
 - 0027
 - 0030
 - 0033
 - 0036
 - 0039
 - 0042
 - 0045
 - 0048
 - 0051
 - 0054

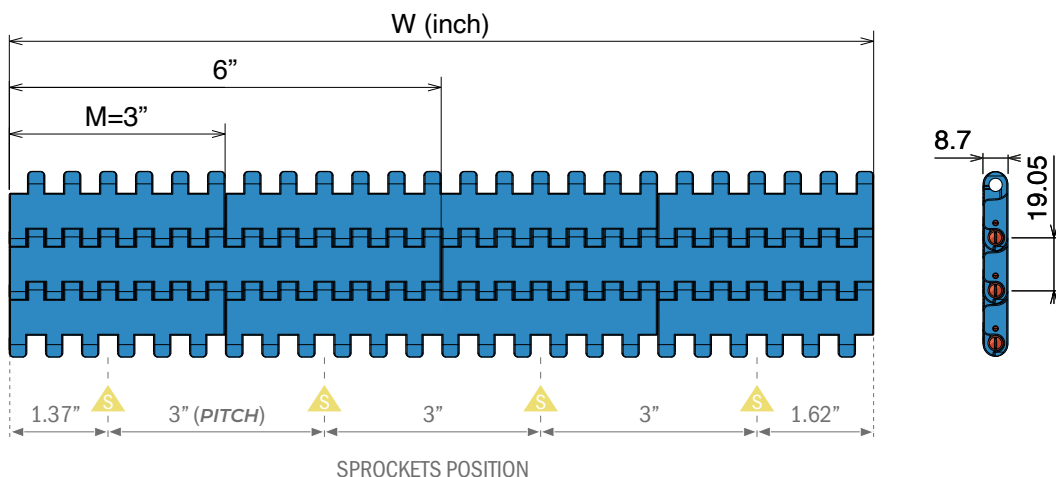

BELT MATERIAL	
POM - Acetal resin	
BELT COLORS	
RAL 5005	Cyan
White	LFA
PINS AVAILABLE	
PBT Pin	PAG Pin
Max w. load: 30000 N/m Weight: 7.2 kg/m ² Temp. range: -40+80 °C	Max w. load: 26000 N/m Weight: 7.2 kg/m ² Temp. range: -40+93 °C
PE Pin	PP Pin
Max w. load: 16000 N/m Weight: 7.2 kg/m ² Temp. range: -40+65 °C	Max w. load: 15000 N/m Weight: 7.2 kg/m ² Temp. range: +5+93 °C

BELT MATERIAL	
PP - Polypropylene	
BELT COLORS	
RAL 5005	Cyan
White	Grey
PINS AVAILABLE	
PBT Pin	PAG Pin
Max w. load: 22500 N/m Weight: 5.2 kg/m ² Temp. range: 0+100 °C	Max w. load: 18000 N/m Weight: 5.2 kg/m ² Temp. range: 0+80 °C
PE Pin	PP Pin
Max w. load: 11000 N/m Weight: 5.2 kg/m ² Temp. range: 0+65 °C	Max w. load: 13000 N/m Weight: 5.2 kg/m ² Temp. range: 0+100 °C

***Belts wider than standard are available with 3 inch increments.**

The nominal tensile strength and the nominal width tolerance are valid for a temperature of 23°C (73 °F).

The actual width of the belt typically falls below the nominal value by 0.1% to 0.3%. For POM belts up to 750 mm (30") in width, the shrinkage ranges from -4 mm to 0 mm, and for those wider, from -0.5% to 0%.

For PP belts up to 750 mm (30") in width, the decrease is between -3 mm and 0 mm, with the reduction for wider belts ranging from -0.25% to 0.25%.

Non-Standard belt widths are incremented by 12.7 mm (0.5"). The minimum width is 76.2 (3.0").

590 FG Flush Grid Tappeto Modulare 590 FG, H=8,7 M=3" / Modular Belt Series 590 FG, H=8,7 M=3" / Modulare Mattenkette 590 FG, H=8,7 M=3"

Backflex radius min.: 25 mm | Pin diameter: 4.25 mm



pg. 41

A

Accessories

pg. 17



pg. 269>286

25.0%
OPEN SURFACE

19.05 mm
PITCH

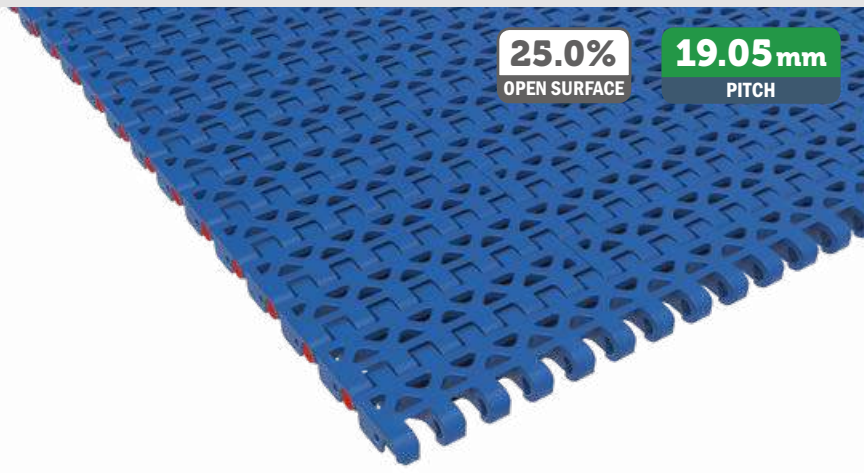

Width* (Inch)

- 0003
- 0006
- 0009
- 0012
- 0015
- 0018
- 0021
- 0024
- 0027
- 0030
- 0033
- 0036
- 0039
- 0042
- 0045
- 0048
- 0051
- 0054

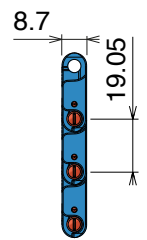
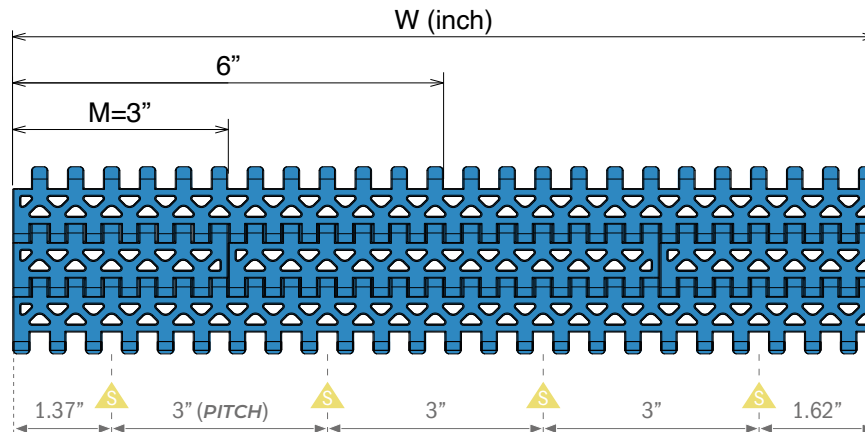

BELT MATERIAL	
POM - Acetal resin	
BELT COLORS	
RAL 5005	Cyan
White	LFA
PINS AVAILABLE	
PBT Pin	PA6 Pin
Max w. load: 30000 N/m	Max w. load: 26000 N/m
Weight: 7.0 kg/m ²	Weight: 7.0 kg/m ²
Temp. range: -40+80 °C	Temp. range: -40+93 °C
PE Pin	PP Pin
Max w. load: 16000 N/m	Max w. load: 15000 N/m
Weight: 7.0 kg/m ²	Weight: 7.0 kg/m ²
Temp. range: -40+65 °C	Temp. range: +5+93 °C

BELT MATERIAL	
PP - Polypropylene	
BELT COLORS	
RAL 5005	Cyan
White	Grey
PINS AVAILABLE	
PBT Pin	PA6 Pin
Max w. load: 22500 N/m	Max w. load: 18000 N/m
Weight: 4.9 kg/m ²	Weight: 4.9 kg/m ²
Temp. range: 0+100 °C	Temp. range: 0+80 °C
PE Pin	PP Pin
Max w. load: 11000 N/m	Max w. load: 13000 N/m
Weight: 4.9 kg/m ²	Weight: 4.9 kg/m ²
Temp. range: 0+65 °C	Temp. range: 0+100 °C

***Belts wider than standard are available with 3 inch increments.**

The nominal tensile strength and the nominal width tolerance are valid for a temperature of 23°C (73 °F).

The actual width of the belt typically falls below the nominal value by 0.1% to 0.3%. For POM belts up to 750 mm (30") in width, the shrinkage ranges from -4 mm to 0 mm, and for those wider, from -0.5% to 0%.

For PP belts up to 750 mm (30") in width, the decrease is between -3 mm and 0 mm, with the reduction for wider belts ranging from -0.25% to 0.25%.

Non-Standard belt widths are incremented by 12.7 mm (0.5"). The minimum width is 76.2 (3.0").

Accessories for 590 Series - Configuration

Straight flight

Closed hinge design

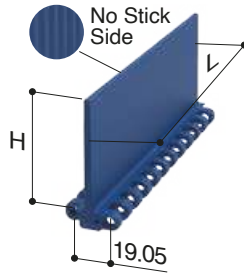

Straight flight modules are available with one smooth side and one side "no-stick" developed to improve handling of wet or sticky food products.

Imperial Size

Technical configuration

Dimensions expressed in millimeter

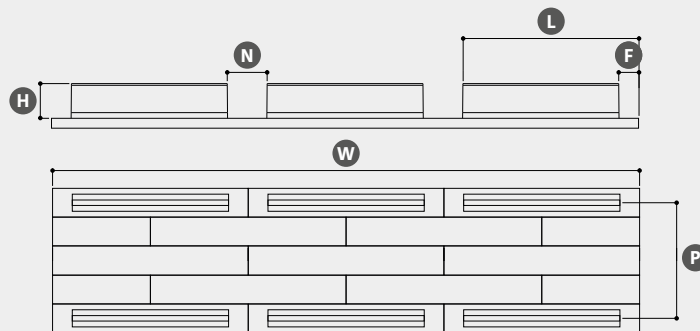

All Accessories have closed hinge design.

Belt surface	Flat Top (FT)				Flush Grid (FG)			
Belt Material & Color	POM - Acetal resin				PP - Polypropylene			
	RAL 5005		Cyan		RAL 5005		Cyan	
	White		LFA		White		Grey	
Pin Material	PBT	PA6	PE	PP	PBT	PA6	PE	PP
W Width	Standard (3"/76,2 mm multiple)		Special (12,7 mm multiple)		Requested quantity	Length (meters)		
H Accessories height	Straight flight							
	25		51		76			
P Pitch	Number of pitches or distance between accessories (19,05 mm multiple)							
F Flight Side Indent	Straight flight							
	0	25	38	50	76,2			
Notch*	No		Single		Double		Triple	
	N Notch width (38 or 76,2 mm multiple)				L Notch distance (2 or more)			

For some combinations the nominal tensile strength of the belt will be reduced due to the accessoris. For different combinations, please ask to your sales representative.

7510

Pitch 25,4 mm
H= 11 mm



7510 FT
7510 NT
7510 DT
7510 MT
Accessories

7510 FT Flat Top Tappeto Modulare 7510 FT, H=11 M=50 Modular Belt Series 7510 FT, H=11 M=50 / Modulare Mattenkette 7510 FT, H=11 M=50

Backflex radius min.: 45 mm | Pin diameter: 5 mm

	A Accessories	
pg. 42/43	pg. 23	pg. 269>286



25.4mm
PITCH

Metric Size

Width* (mm)
0050
0100
0150
0200
0250
0300
0350
0400
0450
0500
0550
0600
0650
0700
0750
0800
0850
0900

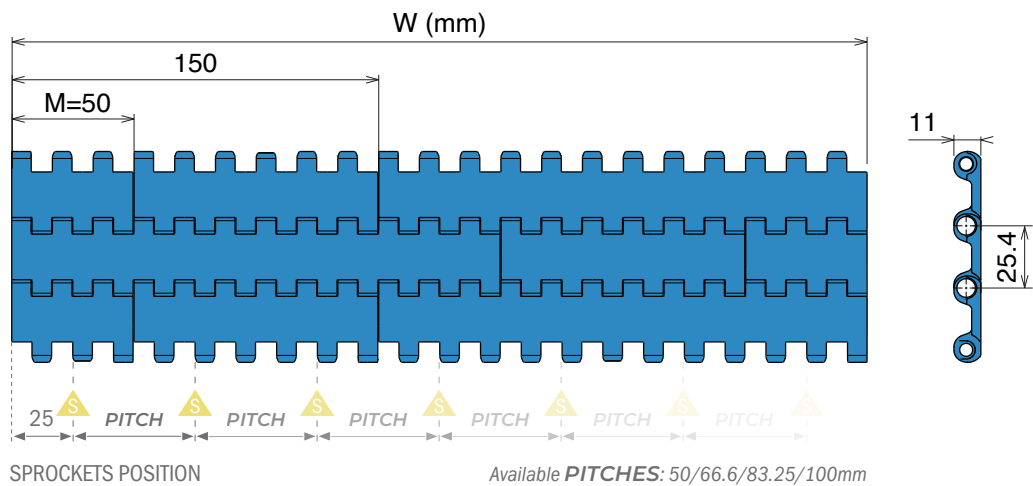

BELT MATERIAL	
PE - Polyethylene	
BELT COLORS	
RAL 5005	Cyan
White	Natural
PINS AVAILABLE	
PBT Pin	PA6 Pin
Max w. load: 8000 N/m Weight: 5.4 kg/m ² Temp. range: -40+65 °C	Max w. load: 8000 N/m Weight: 5.4 kg/m ² Temp. range: -40+65 °C
PE Pin	PP Pin
Max w. load: 8000 N/m Weight: 5.4 kg/m ² Temp. range: -70+65 °C	Max w. load: 8000 N/m Weight: 5.4 kg/m ² Temp. range: 0+65 °C

BELT MATERIAL	
POM - Acetal resin	
BELT COLORS	
RAL 5005	Cyan
White	
PINS AVAILABLE	
PBT Pin	PA6 Pin
Max w. load: 42000 N/m Weight: 7.5 kg/m ² Temp. range: -40+80 °C	Max w. load: 21900 N/m Weight: 7.5 kg/m ² Temp. range: -40+93 °C
PE Pin	PP Pin
Max w. load: 15000 N/m Weight: 7.5 kg/m ² Temp. range: -40+65 °C	Max w. load: 16000 N/m Weight: 7.5 kg/m ² Temp. range: +5+93 °C

BELT MATERIAL	
PP - Polypropylene	
BELT COLORS	
RAL 5005	Cyan
White	
PINS AVAILABLE	
PBT Pin	PA6 Pin
Max w. load: 32000 N/m Weight: 5.2 kg/m ² Temp. range: 0+100 °C	Max w. load: 18600 N/m Weight: 5.2 kg/m ² Temp. range: 0+80 °C
PE Pin	PP Pin
Max w. load: 12000 N/m Weight: 5.2 kg/m ² Temp. range: 0+65 °C	Max w. load: 14000 N/m Weight: 5.2 kg/m ² Temp. range: 0+100 °C

*Belts wider than standard are available with 50 mm increments.

The nominal tensile strength and the nominal width tolerance are valid for a temperature of 23°C (73 °F).

The actual width of the belt typically falls below the nominal value by 0.1% to 0.3%.
For PE belts up to 750 mm (30") in width, the reduction ranges from -5 mm to -1 mm, and for widths beyond that, from -0.75% to 0.35%.
For POM belts up to 750 mm (30") in width, the shrinkage ranges from -4 mm to 0 mm, and for those wider, from -0.3% to -0.1%.
For PP belts up to 750 mm (30") in width, the decrease is between -3 mm and 0 mm, with the reduction for wider belts ranging from -0.4% to 0%.

Non-Standard belt widths are incremented by 16.65 mm (0.66"). The minimum width is 50 mm (2").
Non-bricklaid belts are available in widths of 50 mm (2"), 100 mm (4") and 200 mm (8").

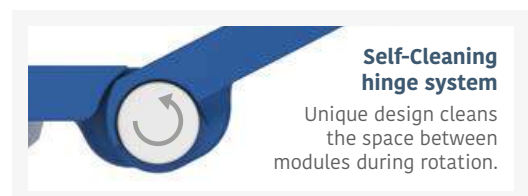

7510 NT

Tappeti modulari / Modular belts / Mattenketten

Belts wider than standard are available with 50 mm increments (standard) or 16.65 inch increments (special)

7510 NT Nub Top Tappeto Modulare 7510 NT, H=11 M=50 Modular Belt Series 7510 NT, H=11 M=50 / Modulare Mattenkette 7510 NT, H=11 M=50

Backflex radius min.: 45 mm | Pin diameter: 5 mm

Metric Size

 pg. 42/43	A Accessories pg. 23	 pg. 269>286
---	-----------------------------------	---

25.4mm
PITCH



Width* (mm)
0050
0100
0150
0200
0250
0300
0350
0400
0450
0500
0550
0600
0650
0700
0750
0800
0850
0900

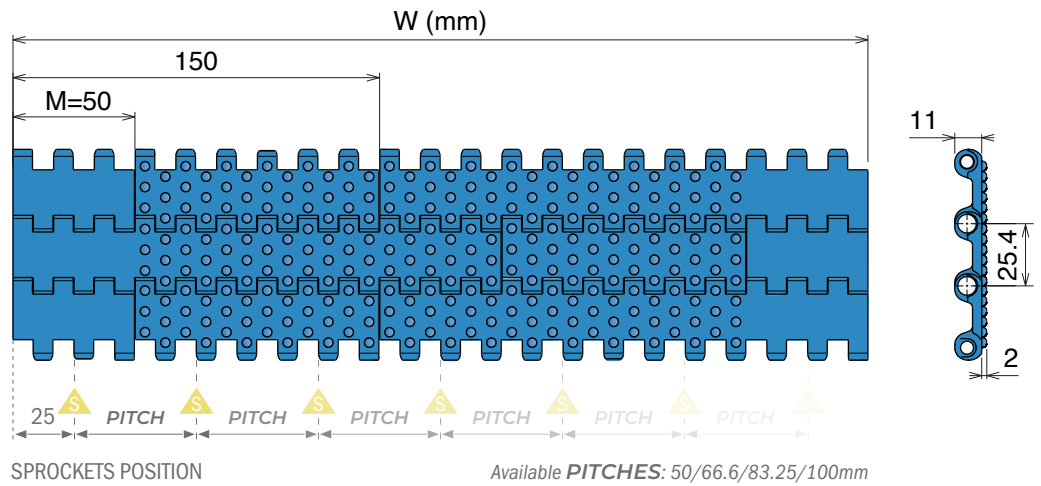

BELT MATERIAL	
PE - Polyethylene	
BELT COLORS	
RAL 5005	Cyan
White	Natural
PINS AVAILABLE	
PBT Pin	PA6 Pin
Max w. load: 8000 N/m Weight: 5.7 kg/m ² Temp. range: -40+65 °C	Max w. load: 8000 N/m Weight: 5.7 kg/m ² Temp. range: -40+65 °C
PE Pin	PP Pin
Max w. load: 8000 N/m Weight: 5.7 kg/m ² Temp. range: -70+65 °C	Max w. load: 8000 N/m Weight: 5.7 kg/m ² Temp. range: 0+65 °C

BELT MATERIAL	
POM - Acetal resin	
BELT COLORS	
RAL 5005	Cyan
White	
PINS AVAILABLE	
PBT Pin	PA6 Pin
Max w. load: 42000 N/m Weight: 7.9 kg/m ² Temp. range: -40+80 °C	Max w. load: 21900 N/m Weight: 7.9 kg/m ² Temp. range: -40+93 °C
PE Pin	PP Pin
Max w. load: 15000 N/m Weight: 7.9 kg/m ² Temp. range: -40+65 °C	Max w. load: 16000 N/m Weight: 7.9 kg/m ² Temp. range: +5+93 °C

BELT MATERIAL	
PP - Polypropylene	
BELT COLORS	
RAL 5005	Cyan
White	
PINS AVAILABLE	
PBT Pin	PA6 Pin
Max w. load: 32000 N/m Weight: 5.5 kg/m ² Temp. range: 0+100 °C	Max w. load: 18600 N/m Weight: 5.5 kg/m ² Temp. range: 0+80 °C
PE Pin	PP Pin
Max w. load: 12000 N/m Weight: 5.5 kg/m ² Temp. range: 0+65 °C	Max w. load: 14000 N/m Weight: 5.5 kg/m ² Temp. range: 0+100 °C

*Belts wider than standard are available with 50 mm increments.

The nominal tensile strength and the nominal width tolerance are valid for a temperature of 23°C (73 °F).

The actual width of the belt typically falls below the nominal value by 0.1% to 0.3%.
For PE belts up to 750 mm (30") in width, the reduction ranges from -5 mm to -2 mm, and for widths beyond that, from -0.75% to 0.35%.
For POM belts up to 750 mm (30") in width, the shrinkage ranges from -3 mm to 0 mm, and for those wider, from -0.4% to 0%.
For PP belts up to 750 mm (30") in width, the decrease is between -3 mm and 0 mm, with the reduction for wider belts ranging from -0.4% to 0%.

Non-Standard belt widths are incremented by 16.65 mm (0.66"). The minimum width is 50 mm (2").
Non-bricklaid belts are available in widths of 50 mm (2"), 100 mm (4") and 200 mm (8").



7510 DT *Diamond Top* Tappeto Modulare 7510 DT, H=11 M=50 Modular Belt Series 7510 DT, H=11 M=50 / Modulare Mattenkette 7510 DT, H=11 M=50

Backflex radius min.: 45 mm | Pin diameter: 5 mm

	A Accessories	
pg. 42/43	pg. 23	pg. 269>286

25.4mm
PITCH



Width* (mm)
0050
0100
0150
0200
0250
0300
0350
0400
0450
0500
0550
0600
0650
0700
0750
0800
0850
0900

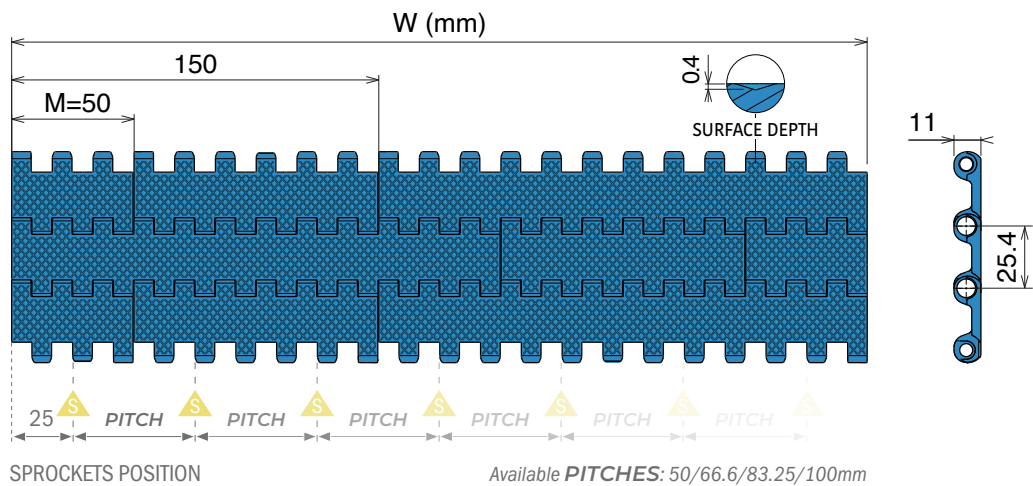

Metric Size

BELT MATERIAL	
PE - Polyethylene	
BELT COLORS	
RAL 5005	Cyan
White	Natural
PINS AVAILABLE	
PBT Pin	PA6 Pin
Max w. load: 8000 N/m Weight: 5.3 kg/m ² Temp. range: -40+65 °C	Max w. load: 8000 N/m Weight: 5.3 kg/m ² Temp. range: -40+65 °C
PE Pin	PP Pin
Max w. load: 8000 N/m Weight: 5.3 kg/m ² Temp. range: -70+65 °C	Max w. load: 8000 N/m Weight: 5.3 kg/m ² Temp. range: 0+65 °C

BELT MATERIAL	
POM - Acetal resin	
BELT COLORS	
RAL 5005	Cyan
White	
PINS AVAILABLE	
PBT Pin	PA6 Pin
Max w. load: 42000 N/m Weight: 7.4 kg/m ² Temp. range: -40+80 °C	Max w. load: 21900 N/m Weight: 7.4 kg/m ² Temp. range: -40+93 °C
PE Pin	PP Pin
Max w. load: 15000 N/m Weight: 7.4 kg/m ² Temp. range: -40+65 °C	Max w. load: 16000 N/m Weight: 7.4 kg/m ² Temp. range: +5+93 °C

BELT MATERIAL	
PP - Polypropylene	
BELT COLORS	
RAL 5005	Cyan
White	
PINS AVAILABLE	
PBT Pin	PA6 Pin
Max w. load: 32000 N/m Weight: 5.1 kg/m ² Temp. range: 0+100 °C	Max w. load: 18600 N/m Weight: 5.1 kg/m ² Temp. range: 0+80 °C
PE Pin	PP Pin
Max w. load: 12000 N/m Weight: 5.1 kg/m ² Temp. range: 0+65 °C	Max w. load: 14000 N/m Weight: 5.1 kg/m ² Temp. range: 0+100 °C

*Belts wider than standard are available with 50 mm increments.

The nominal tensile strength and the nominal width tolerance are valid for a temperature of 23°C (73 °F).

The actual width of the belt typically falls below the nominal value by 0.1% to 0.3%.
For PE belts up to 750 mm (30") in width, the reduction ranges from -5 mm to -1 mm, and for widths beyond that, from -0.75% to 0.35%.
For POM belts up to 750 mm (30") in width, the shrinkage ranges from -4 mm to 0 mm, and for those wider, from -0.3% to -0.1%.
For PP belts up to 750 mm (30") in width, the decrease is between -3 mm and 0 mm, with the reduction for wider belts ranging from -0.4% to 0%.

Non-Standard belt widths are incremented by 16.65 mm (0.66"). The minimum width is 50 mm (2").
Non-bricklaid belts are available in widths of 50 mm (2"), 100 mm (4") and 200 mm (8").



7510 MT

Tappeti modulari / Modular belts / Mattenketten

Belts wider than standard are available with 50 mm increments (standard) or 16.65 inch increments (special)

7510 MT Mesh Top Tappeto Modulare 7510 MT, H=11 M=50 Modular Belt Series 7510 MT, H=11 M=50 / Modulare Mattenkette 7510 MT, H=11 M=50

Backflex radius min.: 45 mm | Pin diameter: 5 mm



pg. 42/43

A

Accessories

pg. 23



pg. 269>286

15.0%
OPEN SURFACE

25.4mm
PITCH



Metric Size

Width* (mm)

0050

0100

0150

0200

0250

0300

0350

0400

0450

0500

0550

0600

0650

0700

0750

0800

0850

0900

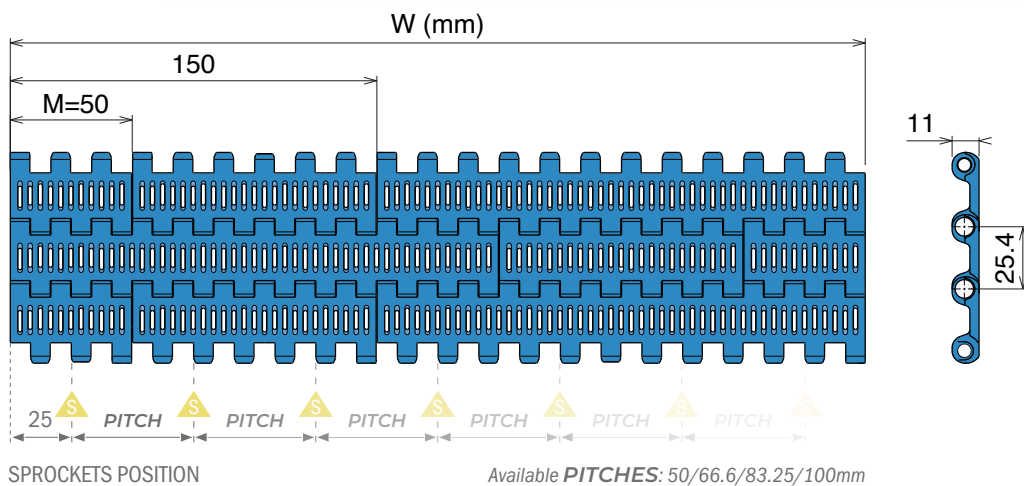

SPROCKETS POSITION

Available PITCHES: 50/66.6/83.25/100mm

BELT MATERIAL

PE - Polyethylene

BELT COLORS

RAL 5005

Cyan

White

Natural

PINS AVAILABLE

PBT Pin

PA6 Pin

Max w. load: 8000 N/m
Weight: 4.9 kg/m²
Temp. range: -40+65 °C

Max w. load: 8000 N/m
Weight: 4.9 kg/m²
Temp. range: -40+65 °C

PE Pin

PP Pin

Max w. load: 8000 N/m
Weight: 4.9 kg/m²
Temp. range: -70+65 °C

Max w. load: 8000 N/m
Weight: 4.9 kg/m²
Temp. range: 0+65 °C

BELT MATERIAL

POM - Acetal resin

BELT COLORS

RAL 5005

Cyan

White

PINS AVAILABLE

PBT Pin

PA6 Pin

Max w. load: 42000 N/m
Weight: 6.7 kg/m²
Temp. range: -40+80 °C

Max w. load: 21900 N/m
Weight: 6.7 kg/m²
Temp. range: -40+93 °C

PE Pin

PP Pin

Max w. load: 15000 N/m
Weight: 6.7 kg/m²
Temp. range: -40+65 °C

Max w. load: 16000 N/m
Weight: 6.7 kg/m²
Temp. range: +5+93 °C

BELT MATERIAL

PP - Polypropylene

BELT COLORS

RAL 5005

Cyan

White

PINS AVAILABLE

PBT Pin

PA6 Pin

Max w. load: 32000 N/m
Weight: 4.7 kg/m²
Temp. range: 0+100 °C

Max w. load: 18600 N/m
Weight: 4.7 kg/m²
Temp. range: 0+80 °C

PE Pin

PP Pin

Max w. load: 12000 N/m
Weight: 4.7 kg/m²
Temp. range: 0+65 °C

Max w. load: 14000 N/m
Weight: 4.7 kg/m²
Temp. range: 0+100 °C

*Belts wider than standard are available with 50 mm increments.

The nominal tensile strength and the nominal width tolerance are valid for a temperature of 23°C (73 °F).

The actual width of the belt typically falls below the nominal value by 0.1% to 0.3%.

For PE belts up to 750 mm (30") in width, the reduction ranges from -4 mm to -1 mm, and for widths beyond that, from -0.75% to -0.35%.

For POM belts up to 750 mm (30") in width, the shrinkage ranges from -4 mm to -1 mm, and for those wider, from -0.75% to -0.35%.

For PP belts up to 750 mm (30") in width, the decrease is between -3 mm and 0 mm, with the reduction for wider belts ranging from -0.4% to 0%.

Non-Standard belt widths are incremented by 16.65 mm (0.66"). The minimum width is 50 mm (2").

Non-bricklaid belts are available in widths of 50 mm (2"), 100 mm (4") and 200 mm (8").



Self-Cleaning hinge system

Unique design cleans the space between modules during rotation.

Tappeti modulari / Modular belts / Mattenketten

Accessories for 7510 Series - Configuration

Straight flight

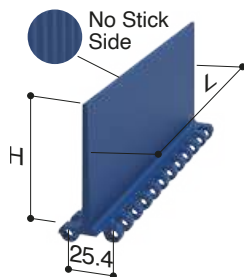

Curved flight

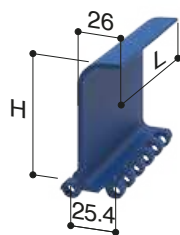

Sidewall

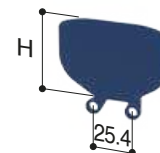

Straight flight modules are available with one smooth side and one side "no-stick" developed to improve handling of wet or sticky food products.

Sidewall modules include both sides, left and right.

Metric Size

Technical configuration

Dimensions expressed in millimeter

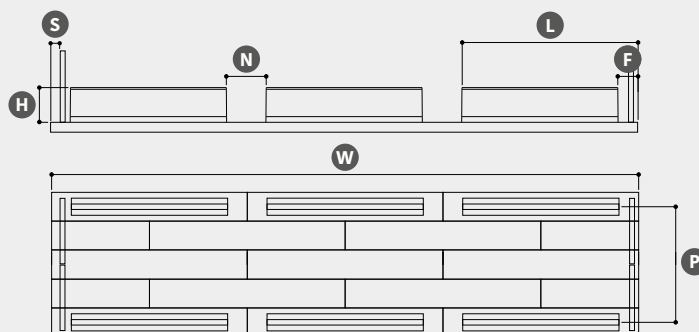

All Accessories have open hinge design.

Belt surface	Flat Top (FT)				Mesh Top (MT)				Nub Top (NT)				Diamond Top (DT)											
Belt Material & Color	PE - Polyethylene								POM - Acetal resin								PP - Polypropylene							
	RAL 5005				Cyan				RAL 5005				Cyan				RAL 5005				Cyan			
	White				Natural				White								White							
Pin Material	PBT	PA6	PE	PP	PBT	PA6	PE	PP	PBT	PA6	PE	PP	PBT	PA6	PE	PP								
W Width	Standard (50 multiple)				Special (16,65 multiple)				Requested quantity				Length (meters)											
H Accessories height	Straight flight								Curved flight				Sidewall											
	25		50		75		100		75				25		50									
P Pitch	Number of pitches or distance between accesories (25,4 mm multiple)																							
F Flight Side Indent	Straight or curved flight only								Straight or curved flight + Sidewalls															
	0		33		50		66,5		83,2		100		33		50		83,2		100					
S Sidewall Side Indent	-		-		-		-		-		-		16.5		33		66,5		83,2					
Notch*	No				Single				Double				Triple											
	N Notch width (16,65 mm multiple)								L Notch distance (2 or more)															

For some combinations the nominal tensile strength of the belt will be reduced due to the accessoris. For different combinations, please ask to your sales representative.

7520

Pitch 25,4 mm
H= 10 mm



7520 FT
7520 FG
Accessories

7520 FT Flat Top Tappeto Modulare 7520 FT, H=10 M=50 Modular Belt Series 7520 FT, H=10 M=50 / Modulare Mattenkette 7520 FT, H=10 M=50

Backflex radius min.: 35 mm | Pin diameter: 5 mm

 pg. 42/43	A Accessories pg. 27	 pg. 269>286
---	-----------------------------------	---

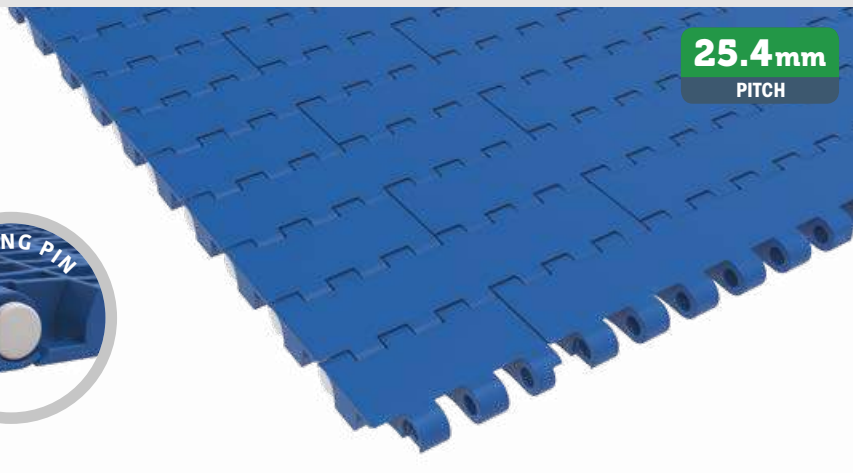

25.4 mm
PITCH

Metric Size

Width* (mm)
0050
0100
0150
0200
0250
0300
0350
0400
0450
0500
0550
0600
0650
0700
0750
0800
0850
0900

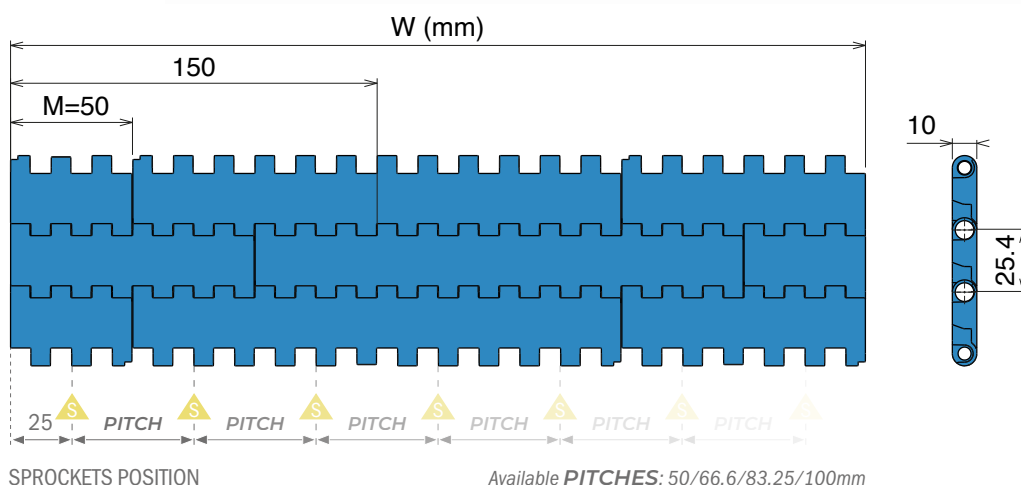

BELT MATERIAL	
PE - Polyethylene	
BELT COLORS	
RAL 5005	Cyan
White	Natural
PINS AVAILABLE	
PBT Pin	PA6 Pin
Max w. load: 10000 N/m Weight: 6.0 kg/m ² Temp. range: -40+65 °C	Max w. load: 10000 N/m Weight: 6.0 kg/m ² Temp. range: -40+65 °C
PE Pin	PP Pin
Max w. load: 9000 N/m Weight: 6.0 kg/m ² Temp. range: -70+65 °C	Max w. load: 9000 N/m Weight: 6.0 kg/m ² Temp. range: 0+65 °C

BELT MATERIAL	
POM - Acetal resin	
BELT COLORS	
RAL 5005	Cyan
White	
PINS AVAILABLE	
PBT Pin	PA6 Pin
Max w. load: 60000 N/m Weight: 8.3 kg/m ² Temp. range: -40+80 °C	Max w. load: 32000 N/m Weight: 8.3 kg/m ² Temp. range: -40+93 °C
PE Pin	PP Pin
Max w. load: 16500 N/m Weight: 8.3 kg/m ² Temp. range: -40+65 °C	Max w. load: 21500 N/m Weight: 8.3 kg/m ² Temp. range: +5+93 °C

BELT MATERIAL	
PP - Polypropylene	
BELT COLORS	
RAL 5005	Cyan
White	
PINS AVAILABLE	
PBT Pin	PA6 Pin
Max w. load: 45000 N/m Weight: 5.7 kg/m ² Temp. range: 0+100 °C	Max w. load: 27000 N/m Weight: 5.7 kg/m ² Temp. range: 0+80 °C
PE Pin	PP Pin
Max w. load: 13000 N/m Weight: 5.7 kg/m ² Temp. range: 0+65 °C	Max w. load: 18000 N/m Weight: 5.7 kg/m ² Temp. range: 0+100 °C

*Belts wider than standard are available with 50 mm increments.

The nominal tensile strength and the nominal width tolerance are valid for a temperature of 23°C (73 °F).

The actual width of the belt typically falls below the nominal value by 0.1% to 0.3%.
For PE belts up to 750 mm (30") in width, the reduction ranges from -3 mm to 1 mm, and for widths beyond that, from -0.4% to 0.1%.
For POM belts up to 750 mm (30") in width, the shrinkage ranges from -2 mm to 1 mm, and for those wider, from -0.25% to -0.25%.
For PP belts up to 750 mm (30") in width, the decrease is between -1 mm and 2 mm, with the reduction for wider belts ranging from 0% to -0.45%.

Non-Standard belt widths are incremented by 16.65 mm (0.66"). The minimum width is 50 mm (2").
Non-bricklaid belts are available in widths of 50 mm (2"), 100 mm (4") and 200 mm (8").

7520 FG Flush Grid Tappeto Modulare 7520 FG, H=10 M=50 Modular Belt Series 7520 FG, H=10 M=50 / Modulare Mattenkette 7520 FG, H=10 M=50

Backflex radius min.: 35 mm | Pin diameter: 5 mm



pg. 42/43

A

Accessories

pg. 27



pg. 269>286

42.0%
OPEN SURFACE

25.4mm
PITCH



Metric Size

Width* (mm)

0050

0100

0150

0200

0250

0300

0350

0400

0450

0500

0550

0600

0650

0700

0750

0800

0850

0900

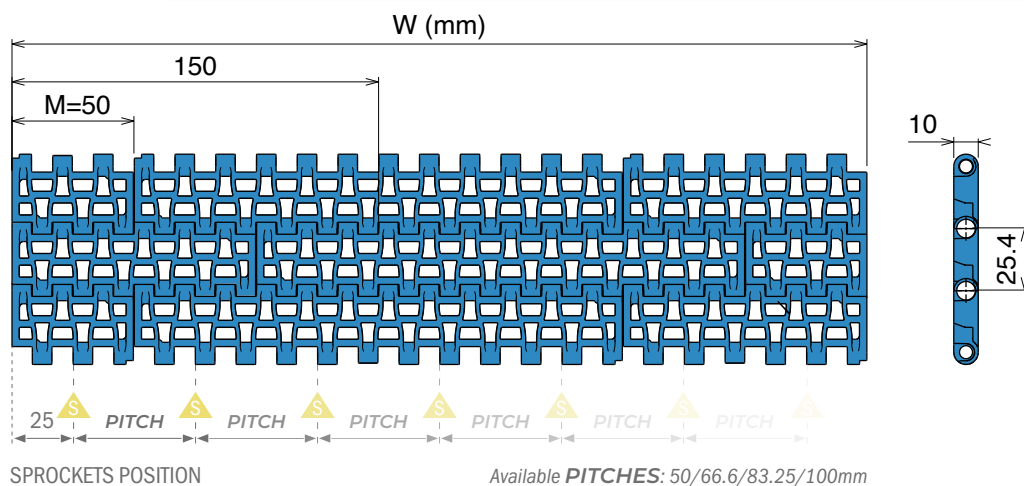

SPROCKETS POSITION

Available PITCHES: 50/66.6/83.25/100mm

BELT MATERIAL

PE - Polyethylene

BELT COLORS

RAL 5005

Cyan

White

Natural

PINS AVAILABLE

PBT Pin

PA6 Pin

Max w. load: 8000 N/m
Weight: 5.2 kg/m²
Temp. range: -40+65 °C

Max w. load: 8000 N/m
Weight: 5.2 kg/m²
Temp. range: -40+65 °C

PE Pin

PP Pin

Max w. load: 8000 N/m
Weight: 5.2 kg/m²
Temp. range: -70+65 °C

Max w. load: 8000 N/m
Weight: 5.2 kg/m²
Temp. range: 0+65 °C

BELT MATERIAL

POM - Acetal resin

BELT COLORS

RAL 5005

Cyan

White

PINS AVAILABLE

PBT Pin

PA6 Pin

Max w. load: 60000 N/m
Weight: 7.2 kg/m²
Temp. range: -40+80 °C

Max w. load: 24700 N/m
Weight: 7.2 kg/m²
Temp. range: -40+93 °C

PE Pin

PP Pin

Max w. load: 15000 N/m
Weight: 7.2 kg/m²
Temp. range: -40+65 °C

Max w. load: 18000 N/m
Weight: 7.2 kg/m²
Temp. range: +5+93 °C

BELT MATERIAL

PP - Polypropylene

BELT COLORS

RAL 5005

Cyan

White

PINS AVAILABLE

PBT Pin

PA6 Pin

Max w. load: 45000 N/m
Weight: 5.0 kg/m²
Temp. range: 0+100 °C

Max w. load: 21000 N/m
Weight: 5.0 kg/m²
Temp. range: 0+80 °C

PE Pin

PP Pin

Max w. load: 12000 N/m
Weight: 5.0 kg/m²
Temp. range: 0+65 °C

Max w. load: 14000 N/m
Weight: 5.0 kg/m²
Temp. range: 0+100 °C

*Belts wider than standard are available with 50 mm increments.

The nominal tensile strength and the nominal width tolerance are valid for a temperature of 23°C (73 °F).

The actual width of the belt typically falls below the nominal value by 0.1% to 0.3%.

For PE belts up to 750 mm (30") in width, the reduction ranges from -5 mm to -1 mm, and for widths beyond that, from -0.8% to -0.3%.

For POM belts up to 750 mm (30") in width, the shrinkage ranges from -3 mm to 0 mm, and for those wider, from -0.4% to 0.1%.

For PP belts up to 750 mm (30") in width, the decrease is between -2 mm and 1 mm, with the reduction for wider belts ranging from -0.4% to 0.1%.

Non-Standard belt widths are incremented by 16.65 mm (0.66"). The minimum width is 50 mm (2").

Non-bricklaid belts are available in widths of 50 mm (2"), 100 mm (4") and 200 mm (8").

Accessories for 7520 Series - Configuration

Straight flight

Closed hinge design

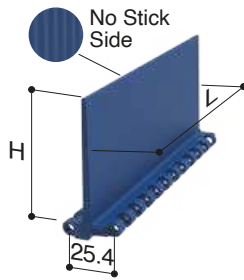

Flush grid flight

Closed hinge design

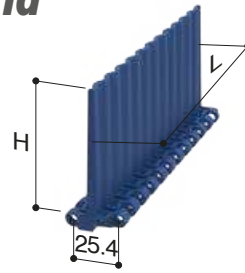

Sidewall

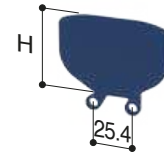

Straight flight modules are available with one smooth side and one side "no-stick" developed to improve handling of wet or sticky food products.

Sidewall modules include both sides, left and right.

Metric Size

Technical configuration

Dimensions expressed in millimeter

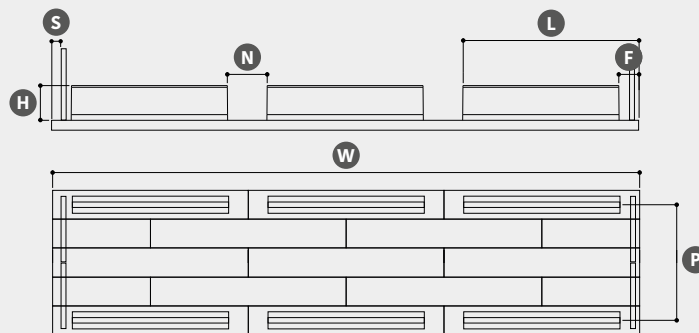

All Accessories have closed hinge design.

Belt surface	Flat Top (FT)				Flush Grid (FG)								
Belt Material & Color	PE - Polyethylene				POM - Acetal resin				PP - Polypropylene				
	RAL 5005		Cyan		RAL 5005		Cyan		RAL 5005		Cyan		
	White		Natural		White				White				
Pin Material	PBT	PA6	PE	PP	PBT	PA6	PE	PP	PBT	PA6	PE	PP	
W Width	Standard (50 multiple)				Special (16,65 multiple)				Requested quantity	Length (meters)			
H Accessories height	Straight flight				Flush grid flight				Sidewall				
	25	50	75	100	75	25	50						
P Pitch	Number of pitches or distance between accessories (25,4 mm multiple)												
F Flight Side Indent	Straight or flush grid flight only						Straight or flush grid flight + Sidewalls						
	0	33	50	66,5	83,2	100	33	50	83,2	100			
S Sidewall Side Indent	-	-	-	-	-	-	16.5	33	66,5	83,2			
Notch*	No		Single		Double		Triple						
	N Notch width (16,65 mm multiple)				L Notch distance (2 or more)								

For some combinations the nominal tensile strength of the belt will be reduced due to the accessoris. For different combinations, please ask to your sales representative.

7010 Series

7010

Pitch 50,8 mm
H= 16 mm

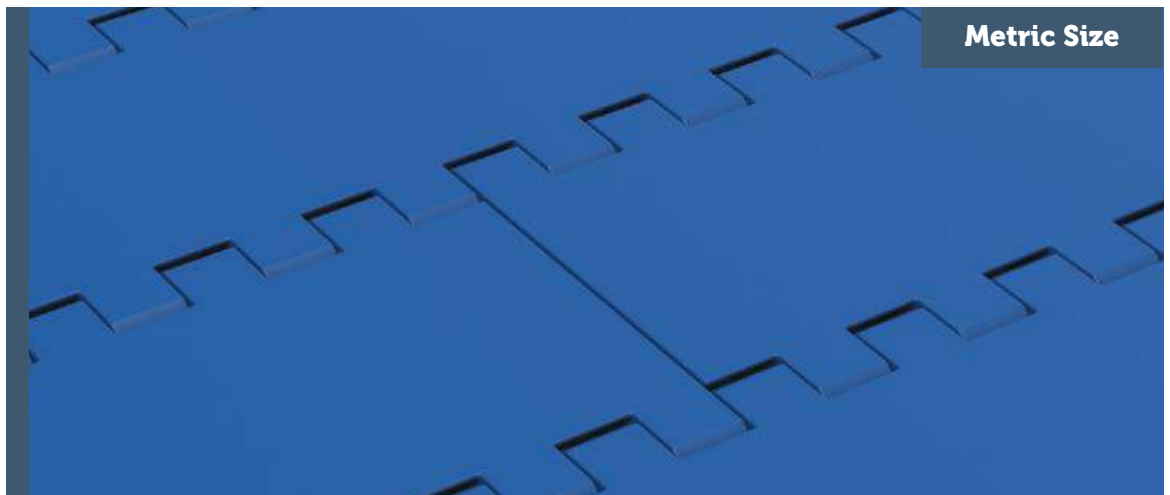

7010 FT
7010 CT
7010 NT
7010 PT
Accessories

Movex®

7010 FT Flat Top Tappeto Modulare 7010 FT, H=16 M=75 Modular Belt Series 7010 FT, H=16 M=75 / Modulare Mattenkette 7010 FT, H=16 M=75

Backflex radius min.: 50 mm | Pin diameter: 7 mm

 pg. 44	A Accessories pg. 33	 pg. 269>286
--	-----------------------------------	---

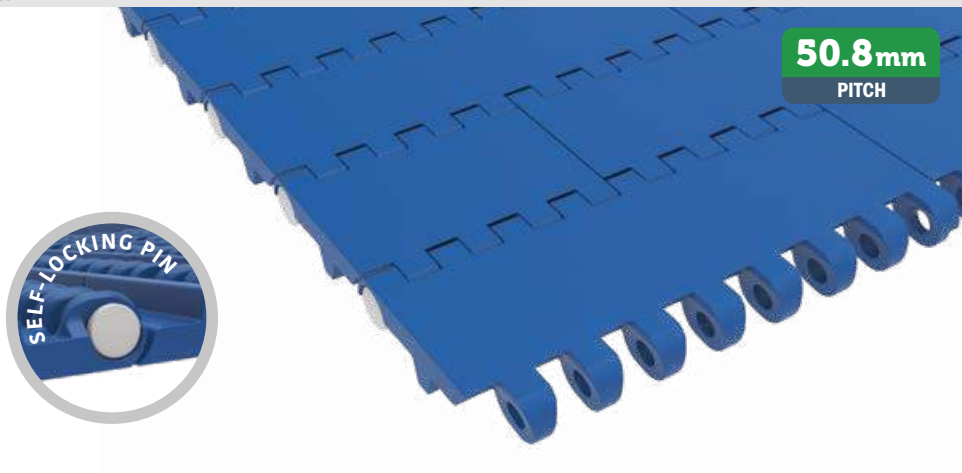

50.8mm
PITCH



Metric Size

- Width* (mm)
- 0075
 - 0150
 - 0225
 - 0300
 - 0375
 - 0450
 - 0525
 - 0600
 - 0675
 - 0750
 - 0825
 - 0900
 - 0975
 - 1050
 - 1125
 - 1200
 - 1275
 - 1350

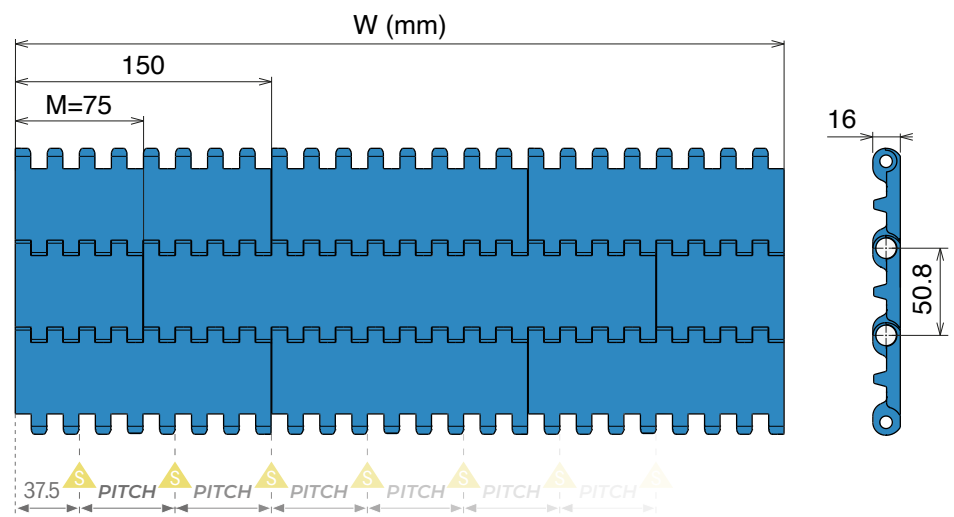

SPROCKETS POSITION Available PITCHES: 56.25/75/93.75/112.5/131.25/150mm

PE - Polyethylene

BELT COLORS AVAILABLE	
RAL 5005	Cyan
White	Natural
PINS AVAILABLE	
PBT Pin	PA6 Pin
Max w. load: 10000 N/m	Max w. load: 10000 N/m
Weight: 9.8 kg/m ²	Weight: 9.8 kg/m ²
Temp. range: -40+65 °C	Temp. range: -40+65 °C
PE Pin	PP Pin
Max w. load: 10000 N/m	Max w. load: 10000 N/m
Weight: 9.8 kg/m ²	Weight: 9.8 kg/m ²
Temp. range: -70+65 °C	Temp. range: 0+65 °C

POM - Acetal resin

BELT COLORS AVAILABLE	
RAL 5005	Cyan
White	
PINS AVAILABLE	
PBT Pin	PA6 Pin
Max w. load: 35000 N/m	Max w. load: 30000 N/m
Weight: 13.9 kg/m ²	Weight: 13.9 kg/m ²
Temp. range: -40+80 °C	Temp. range: -40+93 °C
PE Pin	PP Pin
Max w. load: 18000 N/m	Max w. load: 16000 N/m
Weight: 13.9 kg/m ²	Weight: 13.9 kg/m ²
Temp. range: -40+65 °C	Temp. range: +5+93 °C

PP - Polypropylene

BELT COLORS AVAILABLE	
RAL 5005	Cyan
White	
PINS AVAILABLE	
PBT Pin	PA6 Pin
Max w. load: 26000 N/m	Max w. load: 22000 N/m
Weight: 9.4 kg/m ²	Weight: 9.4 kg/m ²
Temp. range: 0+100 °C	Temp. range: 0+80 °C
PE Pin	PP Pin
Max w. load: 13500 N/m	Max w. load: 14500 N/m
Weight: 9.4 kg/m ²	Weight: 9.4 kg/m ²
Temp. range: 0+65 °C	Temp. range: 0+100 °C

*Belts wider than standard are available with 75 mm increments.

The nominal tensile strength and the nominal width tolerance are valid for a temperature of 23°C (73 °F).

The actual width of the belt typically falls below the nominal value by 0.1% to 0.3%.
 For PE belts up to 750 mm (30") in width, the reduction ranges from -3 mm to 0 mm, and for widths beyond that, from -0.4% to 0%.
 For POM belts up to 750 mm (30") in width, the shrinkage ranges from -3 mm to 0 mm, and for those wider, from -0.4% to 0%.
 For PP belts up to 750 mm (30") in width, the decrease is between -3 mm and 0 mm, with the reduction for wider belts ranging from -0.3% to 0.1%.

Non-Standard belt widths are incremented by 18.75 mm (0.74"). The minimum width is 37.5 mm (1.5").
 Non-bricklaid belts are available in widths of 75 mm (3"), 150 mm (6"), 300 (12") and 600 mm (24").



Self-Cleaning hinge system
 Unique design cleans the space between modules during rotation.

7010 CT Cone Top Tappeto Modulare 7010 CT, H=16 M=75 Modular Belt Series 7010 CT, H=16 M=75 / Modulare Mattenkette 7010 CT, H=16 M=75

Backflex radius min.: 50 mm | Pin diameter: 7 mm

Metric Size

 pg. 44	A Accessories pg. 33	 pg. 269>286
--	-----------------------------------	---

50.8mm
PITCH



Width* (mm)
0075
0150
0225
0300
0375
0450
0525
0600
0675
0750
0825
0900
0975
1050
1125
1200
1275
1350

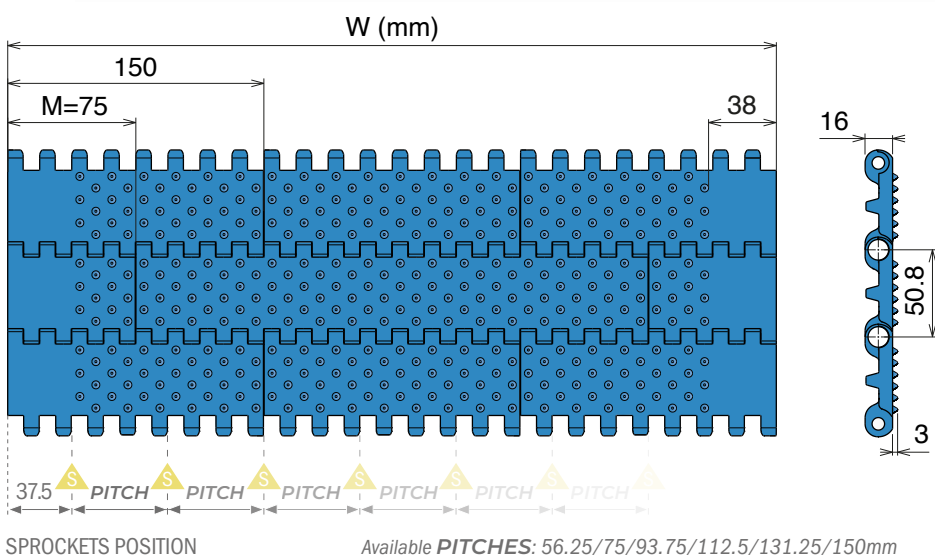

PE - Polyethylene

BELT COLORS AVAILABLE	
RAL 5005	Cyan
White	Natural

PINS AVAILABLE	
PBT Pin	PA6 Pin
Max w. load: 10000 N/m Weight: 9.9 kg/m ² Temp. range: -40+65 °C	Max w. load: 10000 N/m Weight: 9.9 kg/m ² Temp. range: -40+65 °C
PE Pin	PP Pin
Max w. load: 10000 N/m Weight: 9.9 kg/m ² Temp. range: -70+65 °C	Max w. load: 10000 N/m Weight: 9.9 kg/m ² Temp. range: 0+65 °C

POM - Acetal resin

BELT COLORS AVAILABLE	
RAL 5005	Cyan
White	

PINS AVAILABLE	
PBT Pin	PA6 Pin
Max w. load: 35000 N/m Weight: 14.1 kg/m ² Temp. range: -40+80 °C	Max w. load: 30000 N/m Weight: 14.1 kg/m ² Temp. range: -40+93 °C
PE Pin	PP Pin
Max w. load: 18000 N/m Weight: 14.1 kg/m ² Temp. range: -40+65 °C	Max w. load: 16000 N/m Weight: 14.1 kg/m ² Temp. range: +5+93 °C

PP - Polypropylene

BELT COLORS AVAILABLE	
RAL 5005	Cyan
White	

PINS AVAILABLE	
PBT Pin	PA6 Pin
Max w. load: 26000 N/m Weight: 9.5 kg/m ² Temp. range: 0+100 °C	Max w. load: 22000 N/m Weight: 9.5 kg/m ² Temp. range: 0+80 °C
PE Pin	PP Pin
Max w. load: 13500 N/m Weight: 9.5 kg/m ² Temp. range: 0+65 °C	Max w. load: 14500 N/m Weight: 9.5 kg/m ² Temp. range: 0+100 °C

*Belts wider than standard are available with 75 mm increments.

The nominal tensile strength and the nominal width tolerance are valid for a temperature of 23°C (73 °F).

The actual width of the belt typically falls below the nominal value by 0.1% to 0.3%.

For PE belts up to 750 mm (30") in width, the reduction ranges from -3 mm to 0 mm, and for widths beyond that, from -0.4% to 0%.

For POM belts up to 750 mm (30") in width, the shrinkage ranges from -3 mm to 0 mm, and for those wider, from -0.4% to 0%.

For PP belts up to 750 mm (30") in width, the decrease is between -3 mm and 0 mm, with the reduction for wider belts ranging from -0.3% to -0.1%.

Non-Standard belt widths are incremented by 18.75 mm (0.74"). The minimum width is 37.5 mm (1.5").

Non-bricklaid belts are available in widths of 75 mm (3"), 150 mm (6"), 300 (12") and 600 mm (24").



7010 NT *Nub Top* Tappeto Modulare 7010 NT, H=16 M=75 Modular Belt Series 7010 NT, H=16 M=75 / Modulare Mattenkette 7010 NT, H=16 M=75

Backflex radius min.: 50 mm | Pin diameter: 7 mm

 pg. 44	A Accessories pg. 33	 pg. 269>286
---	-----------------------------------	--

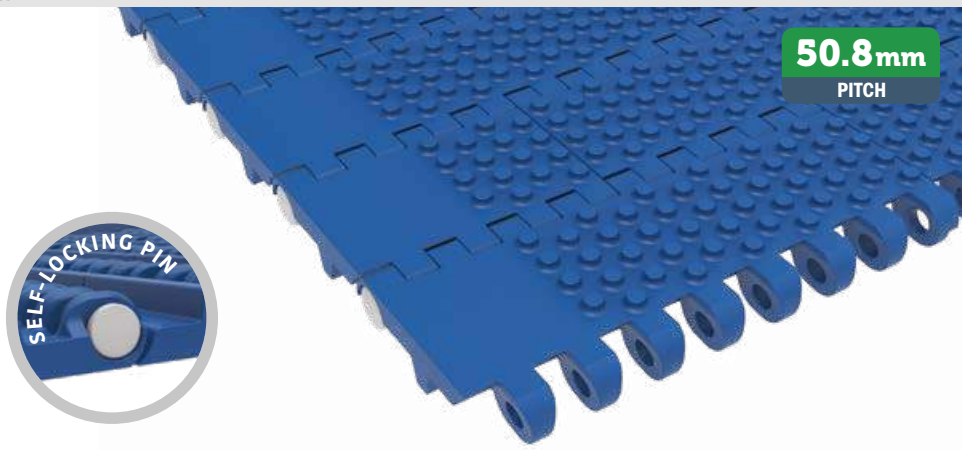

Metric Size

- Width* (mm)
- 0075
 - 0150
 - 0225
 - 0300
 - 0375
 - 0450
 - 0525
 - 0600
 - 0675
 - 0750
 - 0825
 - 0900
 - 0975
 - 1050
 - 1125
 - 1200
 - 1275
 - 1350

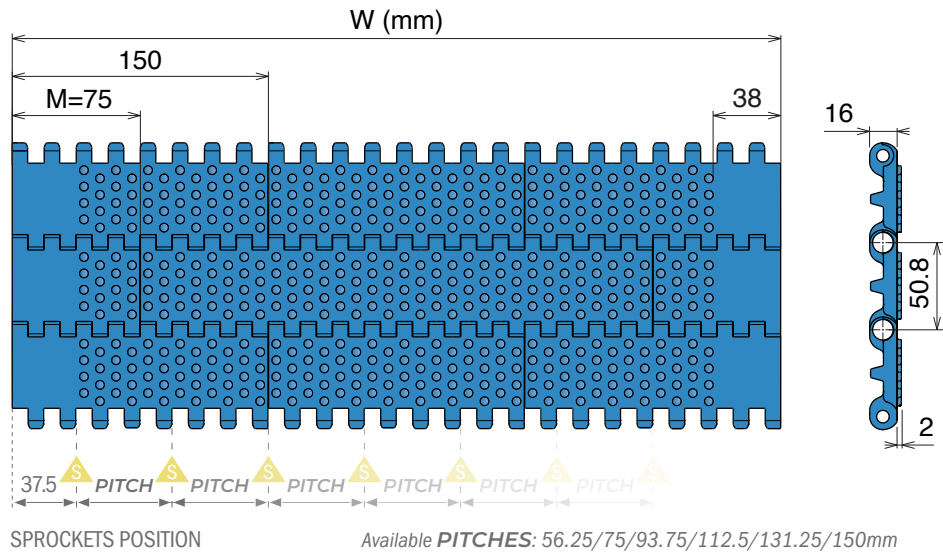

PE - Polyethylene

BELT COLORS AVAILABLE	
RAL 5005	Cyan
White	Natural
PINS AVAILABLE	
PBT Pin	PA6 Pin
Max w. load: 10000 N/m	Max w. load: 10000 N/m
Weight: 10.4 kg/m ²	Weight: 10.4 kg/m ²
Temp. range: -40+65 °C	Temp. range: -40+65 °C
PE Pin	PP Pin
Max w. load: 10000 N/m	Max w. load: 10000 N/m
Weight: 10.4 kg/m ²	Weight: 10.4 kg/m ²
Temp. range: -70+65 °C	Temp. range: 0+65 °C

POM - Acetal resin

BELT COLORS AVAILABLE	
RAL 5005	Cyan
White	
PINS AVAILABLE	
PBT Pin	PA6 Pin
Max w. load: 35000 N/m	Max w. load: 30000 N/m
Weight: 14.6 kg/m ²	Weight: 14.6 kg/m ²
Temp. range: -40+80 °C	Temp. range: -40+93 °C
PE Pin	PP Pin
Max w. load: 18000 N/m	Max w. load: 16000 N/m
Weight: 14.6 kg/m ²	Weight: 14.6 kg/m ²
Temp. range: -40+65 °C	Temp. range: +5+93 °C

PP - Polypropylene

BELT COLORS AVAILABLE	
RAL 5005	Cyan
White	
PINS AVAILABLE	
PBT Pin	PA6 Pin
Max w. load: 26000 N/m	Max w. load: 22000 N/m
Weight: 10.0 kg/m ²	Weight: 10.0 kg/m ²
Temp. range: 0+100 °C	Temp. range: 0+80 °C
PE Pin	PP Pin
Max w. load: 13500 N/m	Max w. load: 14500 N/m
Weight: 10.0 kg/m ²	Weight: 10.0 kg/m ²
Temp. range: 0+65 °C	Temp. range: 0+100 °C

*Belts wider than standard are available with 75 mm increments.

The nominal tensile strength and the nominal width tolerance are valid for a temperature of 23°C (73 °F).

The actual width of the belt typically falls below the nominal value by 0.1% to 0.3%.
 For PE belts up to 750 mm (30") in width, the reduction ranges from -3 mm to 0 mm, and for widths beyond that, from 0.4% to 0%.
 For POM belts up to 750 mm (30") in width, the shrinkage ranges from -3 mm to 0 mm, and for those wider, from -0.4% to -0%.
 For PP belts up to 750 mm (30") in width, the decrease is between -3 mm and 0 mm, with the reduction for wider belts ranging from -0.4% to 0%.

Non-Standard belt widths are incremented by 18.75 mm (0.74"). The minimum width is 37.5 mm (1.5").
 Non-bricklaid belts are available in widths of 75 mm (3"), 150 mm (6"), 300 (12") and 600 mm (24").



Self-Cleaning hinge system
 Unique design cleans the space between modules during rotation.

7010 PT

Tappeti modulari / Modular belts / Mattenketten

Belts wider than standard are available with 75 mm increments (standard) or 18.75 inch increments (special)

7010 PT Perforated Top Tappeto Modulare 7010 PT, H=16 M=75 Modular Belt Series 7010 PT, H=16 M=75 / Modulare Mattenkette 7010 PT, H=16 M=75

Backflex radius min.: 50 mm | Pin diameter: 7 mm



pg. 44

A
Accessories

pg. 33



pg. 269-286

15.0%
OPEN SURFACE

50.8mm
PITCH

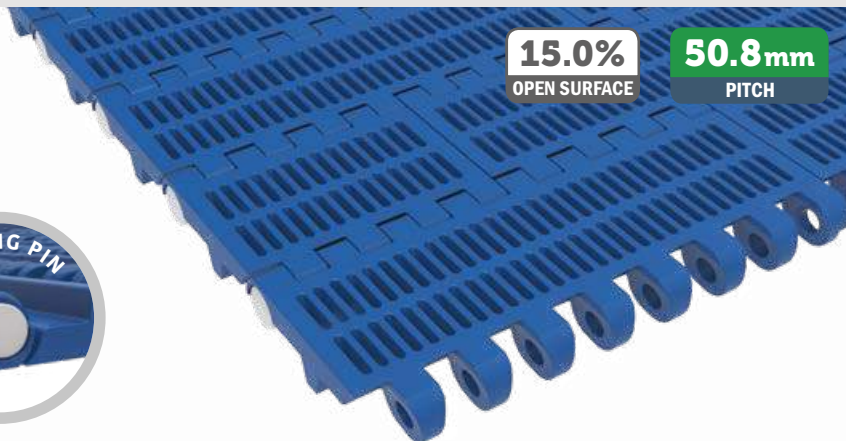

Metric Size

Width* (mm)

0075

0150

0225

0300

0375

0450

0525

0600

0675

0750

0825

0900

0975

1050

1125

1200

1275

1350

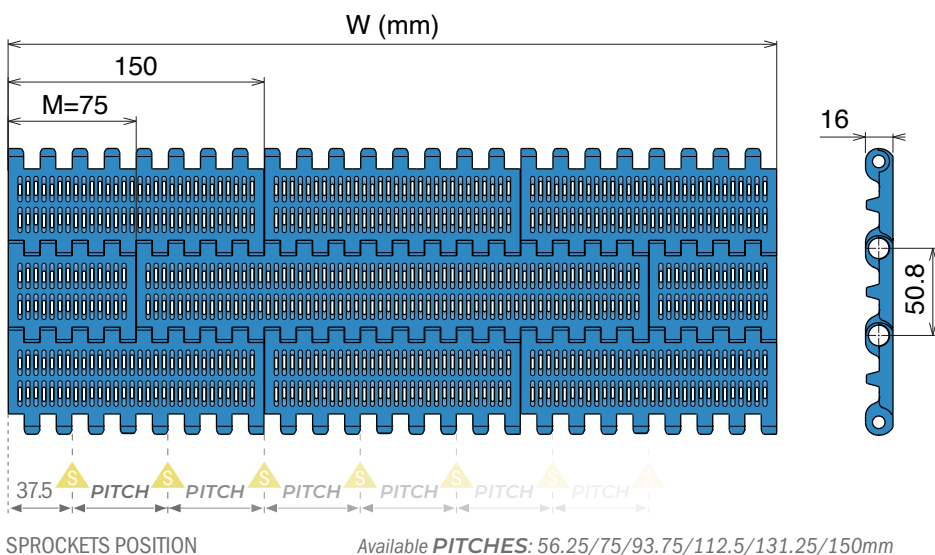

PE - Polyethylene

BELT COLORS AVAILABLE	
RAL 5005	Cyan
White	Natural
PINS AVAILABLE	
PBT Pin	PA6 Pin
Max w. load: 10000 N/m	Max w. load: 10000 N/m
Weight: 8.4 kg/m ²	Weight: 8.4 kg/m ²
Temp. range: -40+65 °C	Temp. range: -40+65 °C
PE Pin	PP Pin
Max w. load: 10000 N/m	Max w. load: 10000 N/m
Weight: 8.4 kg/m ²	Weight: 8.4 kg/m ²
Temp. range: -70+65 °C	Temp. range: 0+65 °C

POM - Acetal resin

BELT COLORS AVAILABLE	
RAL 5005	Cyan
White	
PINS AVAILABLE	
PBT Pin	PA6 Pin
Max w. load: 35000 N/m	Max w. load: 30000 N/m
Weight: 11.8 kg/m ²	Weight: 11.8 kg/m ²
Temp. range: -40+80 °C	Temp. range: -40+93 °C
PE Pin	PP Pin
Max w. load: 18000 N/m	Max w. load: 16000 N/m
Weight: 11.8 kg/m ²	Weight: 11.8 kg/m ²
Temp. range: -40+65 °C	Temp. range: +5+93 °C

PP - Polypropylene

BELT COLORS AVAILABLE	
RAL 5005	Cyan
White	
PINS AVAILABLE	
PBT Pin	PA6 Pin
Max w. load: 26000 N/m	Max w. load: 22000 N/m
Weight: 8.0 kg/m ²	Weight: 8.0 kg/m ²
Temp. range: 0+100 °C	Temp. range: 0+80 °C
PE Pin	PP Pin
Max w. load: 13500 N/m	Max w. load: 14500 N/m
Weight: 8.0 kg/m ²	Weight: 8.0 kg/m ²
Temp. range: 0+65 °C	Temp. range: 0+100 °C

*Belts wider than standard are available with 75 mm increments.

The nominal tensile strength and the nominal width tolerance are valid for a temperature of 23°C (73 °F).

The actual width of the belt typically falls below the nominal value by 0.1% to 0.3%.

For PE belts up to 750 mm (30") in width, the reduction ranges from -3 mm to 1 mm, and for widths beyond that, from -0.3% to 0.3%.

For POM belts up to 750 mm (30") in width, the shrinkage ranges from -3 mm to 0 mm, and for those wider, from -0.4% to 0%.

For PP belts up to 750 mm (30") in width, the decrease is between -2 mm and 1 mm, with the reduction for wider belts ranging from -0.3% to 0.1%.

Non-Standard belt widths are incremented by 18.75 mm (0.74"). The minimum width is 37.5 mm (1.5").

Non-bricklaid belts are available in widths of 75 mm (3"), 150 mm (6"), 300 (12") and 600 mm (24").



Tappeti modulari / Modular belts / Mattenketten

Accessories for 7010 Series - Configuration

Straight flight

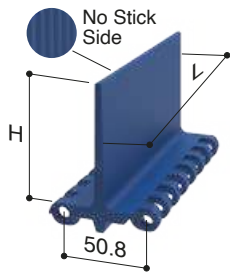

Curved flight

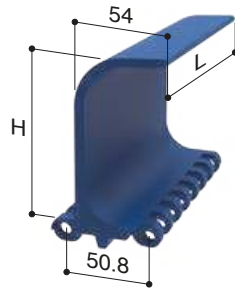

Sidewall

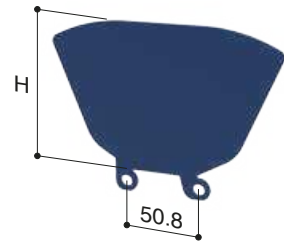

Metric Size

Straight flight modules are available with one smooth side and one side "no-stick" developed to improve handling of wet or sticky food products.

Sidewall modules include both sides, left and right.

Technical configuration

Dimensions expressed in millimeter

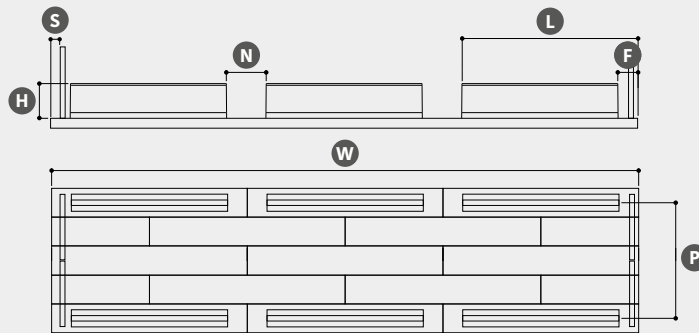

All Accessories have open hinge design.

Belt surface	Flat Top (FT)				Cone Top (CT)				Nub Top (NT)				Perforated Top (PT)											
Belt Material & Color	PE - Polyethylene								POM - Acetal resin								PP - Polypropylene							
	RAL 5005				Cyan				RAL 5005				Cyan				RAL 5005				Cyan			
	White				Natural				White								White							
Pin Material	PBT	PA6	PE	PP	PBT	PA6	PE	PP	PBT	PA6	PE	PP	PBT	PA6	PE	PP								
W Width	Standard (75 multiple)				Special (18,75 multiple)				Requested quantity				Length (meters)											
H Accessories height	Straight flight								Curved flight				Sidewall											
	25	50	75	100	150	75	100	150	50	75	100													
P Pitch	Number of pitches or distance between accesories (50,8 mm multiple)																							
F Flight Side Indent	Straight or curved flight only								Straight or curved flight + Sidewalls															
	0	37,5	56	75	112	131	37,5	56	75	112	131													
S Sidewall Side Indent	-	-	-	-	-	-	18	37	56	93	112													
Notch*	No				Single				Double				Triple											
	N Notch width (37,5 mm multiple)								L Notch distance (2 or more)															

For some combinations the nominal tensile strength of the belt will be reduced due to the accessoris. For different combinations, please ask to your sales representative.

ZERO CONTACT

ZER⁵²⁰CONTACT

SIDE FLEX MODULAR BELT

H= 10.1 mm

Metric Size



ZERO CONTACT
ZERO CONTACT PRO



Movex[®]

ZERO CONTACT

Tappeto Modulare Curvilineo Zero Contact™, H=10,1 M=200

Side Flex Modular Belt Zero Contact™, H=10,1 M=200 / Kurvengängige Mattenkette Zero Contact™, H=10,1 M=200

Pin diameter: 4.7 mm

	Zero contact Curve	
pg. 45	pg. 48>55	pg. 269>286

SAMPLE BOX

Art.-Nr. **599999925A**

Material

LFB - Code 23
Low friction Acetal

LFA - Code 01
Low friction Acetal

Max w. load: 13500 N/m	Max w. load: 13500 N/m
Weight: 9,25 kg/m ²	Weight: 9,25 kg/m ²
Temp. range dry: -40+80 °C	Temp. range dry: -40+80 °C
Temp. range wet: -40+65 °C	Temp. range wet: -40+65 °C
Pin material: PBT white	Pin material: PBT white

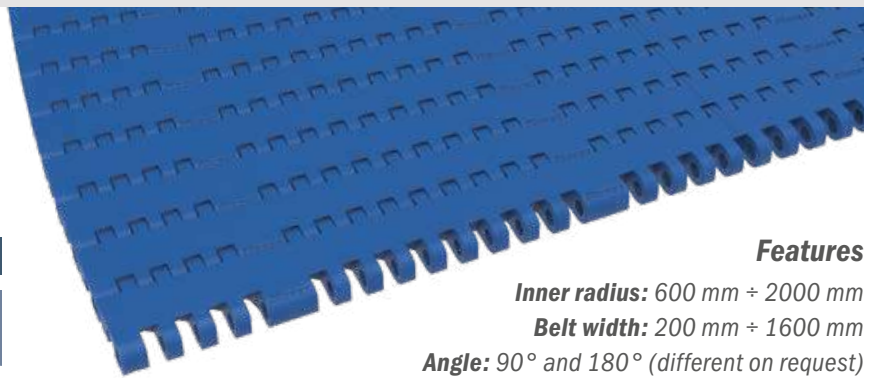

Features

Inner radius: 600 mm ÷ 2000 mm

Belt width: 200 mm ÷ 1600 mm

Angle: 90° and 180° (different on request)

Row to row angle: 1,33°

Pin material: Ø4,7 mm, PBT White

Open Area: 0%

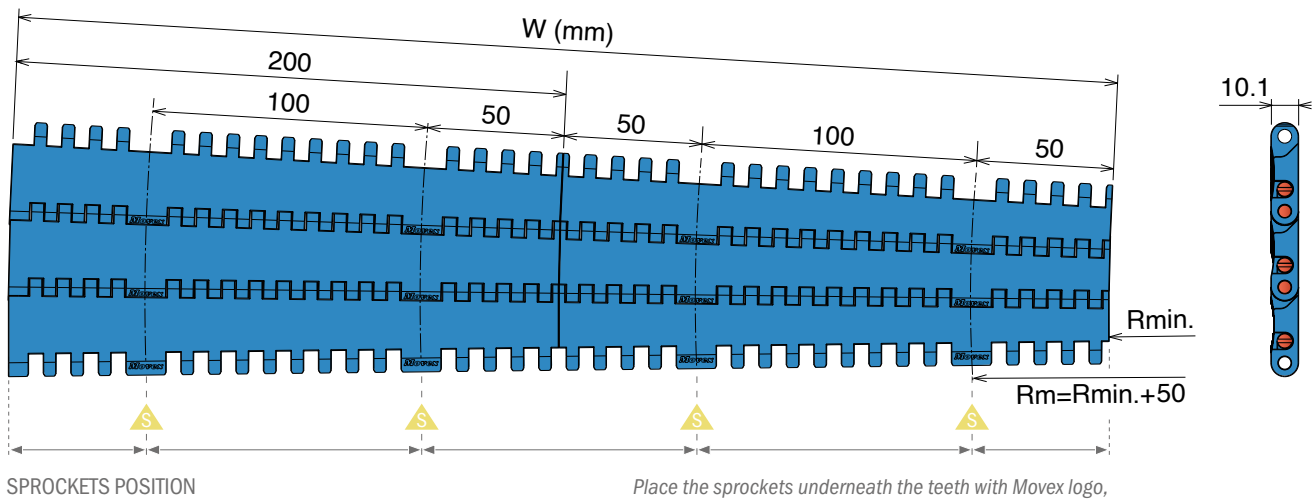

Movex® Zero Contact™ modular fixed radius curve belt is the best choice for all type of transportation, for beverage, food and logistic industries, thanks to its versatility.

It offers high performances, reducing the coefficient of friction between product and running belt surface and improves the efficiency of the line, by minimizing downtimes.

A wide range of radii and widths helps finding the right solution for every product dimension and transportation condition, from light packages to heavier ones.

Installation and maintenance have never been so easy, so far.



The belt is compliant to: • Regulation: D.P.R. 777 - 23 August 1982 e D.L. 108 - 25 January 1992; • UNI EN 1186 1+15:2003

• D.M. 34 del 21.3.73 S.O. GU n° 104 - 20/04/73 and following updates • Regulation (EU) n. 10/2011, GUUE L 12 del 15/01/2011 and following updates. • Regulations (CE) n. 1935/2004 GUCE L 338 del 13/11/04 and n. 1895/2005 GUCE L 302 - 19/11/2005.



Low friction



Minimized maintenance



Easy pin removal

ZERO CONTACT

SIDE FLEX MODULAR BELT

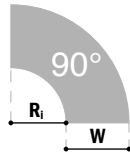

Side Flex Modular Belt Zero Contact™ 90° | Length of the belt 150 Modules

Belt Width	R _i 600	R _i 800	R _i 1000	R _i 1200	R _i 1400	R _i 1600	R _i 1800	R _i 2000	Material
200	5451230201A	5451230202A	5451230203A	5451230204A	5451230205A	5451230206A	5451230207A	5451230208A	LFB
400	5451230401A	5451230402A	5451230403A	5451230404A	5451230405A	5451230406A	5451230407A	-	
600	5451230601A	5451230602A	5451230603A	5451230604A	5451230605A	5451230606A	-	-	
800	5451230801A	5451230802A	5451230803A	5451230804A	5451230805A	-	-	-	
1000	5451231001A	5451231002A	5451231003A	5451231004A	-	-	-	-	
1200	5451231201A	5451231202A	5451231203A	-	-	-	-	-	
1400	5451231401A	5451231402A	-	-	-	-	-	-	
1600	5451231601A	-	-	-	-	-	-	-	

Side Flex Modular Belt Zero Contact™ 90° | Length of the belt 150 Modules

Belt Width	R _i 600	R _i 800	R _i 1000	R _i 1200	R _i 1400	R _i 1600	R _i 1800	R _i 2000	Material
200	5451010201A	5451010202A	5451010203A	5451010204A	5451010205A	5451010206A	5451010207A	5451010208A	LFA
400	5451010401A	5451010402A	5451010403A	5451010404A	5451010405A	5451010406A	5451010407A	-	
600	5451010601A	5451010602A	5451010603A	5451010604A	5451010605A	5451010606A	-	-	
800	5451010801A	5451010802A	5451010803A	5451010804A	5451010805A	-	-	-	
1000	5451011001A	5451011002A	5451011003A	5451011004A	-	-	-	-	
1200	5451011201A	5451011202A	5451011203A	-	-	-	-	-	
1400	5451011401A	5451011402A	-	-	-	-	-	-	
1600	5451011601A	-	-	-	-	-	-	-	

ZERO CONTACT

SIDE FLEX MODULAR BELT

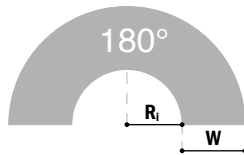

Side Flex Modular Belt Zero Contact™ 180° | Length of the belt 285 Modules

Belt Width	R _i 600	R _i 800	R _i 1000	R _i 1200	R _i 1400	R _i 1600	R _i 1800	R _i 2000	Material
200	5452230201A	5452230202A	5452230203A	5452230204A	5452230205A	5452230206A	5452230207A	5452230208A	LFB
400	5452230401A	5452230402A	5452230403A	5452230404A	5452230405A	5452230406A	5452230407A	-	
600	5452230601A	5452230602A	5452230603A	5452230604A	5452230605A	5452230606A	-	-	
800	5452230801A	5452230802A	5452230803A	5452230804A	5452230805A	-	-	-	
1000	5452231001A	5452231002A	5452231003A	5452231004A	-	-	-	-	
1200	5452231201A	5452231202A	5452231203A	-	-	-	-	-	
1400	5452231401A	5452231402A	-	-	-	-	-	-	
1600	5452231601A	-	-	-	-	-	-	-	

Side Flex Modular Belt Zero Contact™ 180° | Length of the belt 285 Modules

Belt Width	R _i 600	R _i 800	R _i 1000	R _i 1200	R _i 1400	R _i 1600	R _i 1800	R _i 2000	Material
200	5452010201A	5452010202A	5452010203A	5452010204A	5452010205A	5452010206A	5452010207A	5452010208A	LFA
400	5452010401A	5452010402A	5452010403A	5452010404A	5452010405A	5452010406A	5452010407A	-	
600	5452010601A	5452010602A	5452010603A	5452010604A	5452010605A	5452010606A	-	-	
800	5452010801A	5452010802A	5452010803A	5452010804A	5452010805A	-	-	-	
1000	5452011001A	5452011002A	5452011003A	5452011004A	-	-	-	-	
1200	5452011201A	5452011202A	5452011203A	-	-	-	-	-	
1400	5452011401A	5452011402A	-	-	-	-	-	-	
1600	5452011601A	-	-	-	-	-	-	-	

ZERO CONTACT PRO

Tappeto Modulare Curvilineo Zero Contact PRO, H=9

Side Flex Modular Belt Zero Contact PRO, H=9 / Kurvengängige Mattenkette Zero Contact PRO, H=9

Pin diameter: 4 mm

	Zero contact Pro Curve	
pg. 45	pg. 56>59	pg. 269>286

The sprocket positioning for this belt series is detailed in the Movex engineering manual

SAMPLE BOX

Art.-Nr. **5999999925A**

Material

PA - Code 28

Glass fiber reinforced

Max w. load: 19000 N/m
 Weight: 9,25 kg/m²
 Temp. range dry: -30÷100 °C
 Temp. range wet: N.R.
 Pin: Stainless steel

ZERO CONTACT PRO
 SIDE FLEX MODULAR BELT

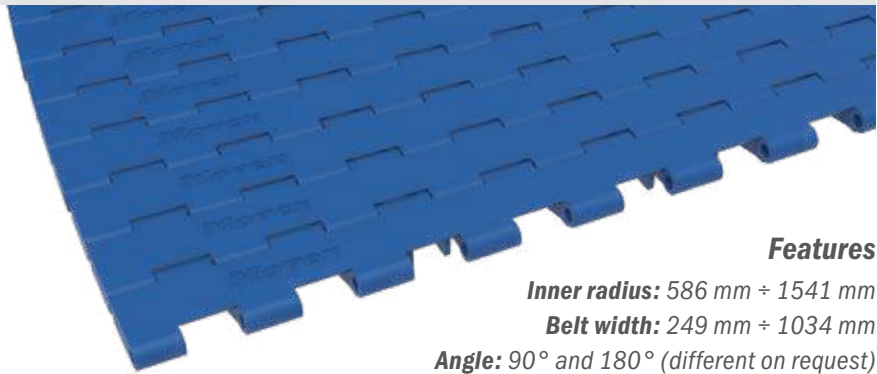
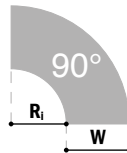

Features

Inner radius: 586 mm ÷ 1541 mm

Belt width: 249 mm ÷ 1034 mm

Angle: 90° and 180° (different on request)

Row to row angle: 1°

Pin: Ø4 mm, material 1.4301

Open Area: 0%

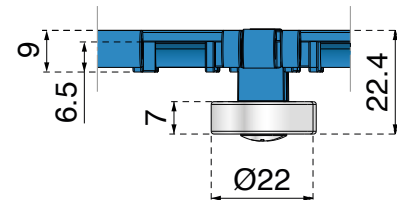

Side Flex Modular Belt Zero Contact PRO™ 90° | Without bearings | Length of the belt 200 modules

Order code	R _i - mm	W - mm	Order code	R _i - mm	W - mm	Order code	R _i - mm	W - mm
5461280439A-M	586	439	5462281034A-M	756	1034	5464280504A-M	1116	504
5461280524A-M	586	524	5463280269A-M	1011	269	5465280419A-M	1201	419
5461280864A-M	586	864	5463280439A-M	1011	439	5466280249A-M	1286	249
5461281034A-M	586	1034	5463280524A-M	1011	524	5465280504A-M	1286	504
5462280269A-M	756	269	5463280864A-M	1011	864	5466280419A-M	1456	419
5462280439A-M	756	439	5463281034A-M	1011	1034	5466280504A-M	1541	504
5462280524A-M	756	524	5465280249A-M	1031	249			
5462280864A-M	756	864	5464280419A-M	1031	419			

Side Flex Modular Belt Zero Contact PRO™ 90° | With bearings | Length of the belt 200 modules

Order code	R _i - mm	W - mm	Order code	R _i - mm	W - mm
5462280249A-M	1031	249	5463280249A-M	1286	249
5461280419A-M	1031	419	5462280504A-M	1286	504
5461280504A-M	1116	504	5463280419A-M	1456	419
5462280419A-M	1201	419	5463280504A-M	1541	504



Side Flex Modular Belt Zero Contact PRO™ 90° | Two track combinations | Length of the belts 200 modules

Track 1 - Order code	R _i - mm	W - mm		Track 2 - Order code	R _i - mm	W - mm	Total width
5462280269A-M	756	269	+	5462280249A-M	1031	249	= 524
5463280269A-M	1011	269	+	5463280249A-M	1286	249	= 524
5461280439A-M	586	439	+	5461280419A-M	1031	419	= 864
5462280439A-M	756	439	+	5462280419A-M	1201	419	= 864
5463280439A-M	1011	439	+	5463280419A-M	1456	419	= 864
5461280524A-M	586	524	+	5461280504A-M	1116	504	= 1034
5462280524A-M	756	524	+	5462280504A-M	1286	504	= 1034
5463280524A-M	1011	524	+	5463280504A-M	1541	504	= 1034

The gap between the belts is 6 mm. | Track 1 belt is supplied without bearings. | Track 2 belt is supplied with bearings.

ZERO CONTACT PRO

Tappeti modulari / Modular belts / Mattenketten

ZERO CONTACT
SIDE FLEX MODULAR BELT

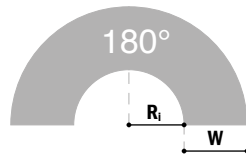

Side Flex Modular Belt Zero Contact PRO™ 180° | Without bearings | Length of the belt 380 modules

Order code	R ₁ - mm	W - mm	Order code	R ₁ - mm	W - mm	Order code	R ₁ - mm	W - mm
5461280439B-M	586	439	5462281034B-M	756	1034	5464280504B-M	1116	504
5461280524B-M	586	524	5463280269B-M	1011	269	5465280419B-M	1201	419
5461280864B-M	586	864	5463280439B-M	1011	439	5466280249B-M	1286	249
5461281034B-M	586	1034	5463280524B-M	1011	524	5465280504B-M	1286	504
5462280269B-M	756	269	5463280864B-M	1011	864	5466280419B-M	1456	419
5462280439B-M	756	439	5463281034B-M	1011	1034	5466280504B-M	1541	504
5462280524B-M	756	524	5465280249B-M	1031	249			
5462280864B-M	756	864	5464280419B-M	1031	419			

Side Flex Modular Belt Zero Contact PRO™ 180° | With bearings | Length of the belt 380 modules

Order code	R ₁ - mm	W - mm	Order code	R ₁ - mm	W - mm
5462280249B-M	1031	249	5463280249B-M	1286	249
5461280419B-M	1031	419	5462280504B-M	1286	504
5461280504B-M	1116	504	5463280419B-M	1456	419
5462280419B-M	1201	419	5463280504B-M	1541	504



Side Flex Modular Belt Zero Contact PRO™ 180° | Two track combinations | Length of the belts 380 modules

Track 1 - Order code	R ₁ - mm	W - mm		Track 2 - Order code	R ₁ - mm	W - mm	Total width
5462280269B-M	756	269	+	5462280249B-M	1031	249	= 524
5463280269B-M	1011	269	+	5463280249B-M	1286	249	= 524
5461280439B-M	586	439	+	5461280419B-M	1031	419	= 864
5462280439B-M	756	439	+	5462280419B-M	1201	419	= 864
5463280439B-M	1011	439	+	5463280419B-M	1456	419	= 864
5461280524B-M	586	524	+	5461280504B-M	1116	504	= 1034
5462280524B-M	756	524	+	5462280504B-M	1286	504	= 1034
5463280524B-M	1011	524	+	5463280504B-M	1541	504	= 1034

The gap between the belts is 6 mm. | Track 1 belt is supplied without bearings. | Track 2 belt is supplied with bearings.

The innovative design of **Movex® Zero Contact™ PRO** is recommended for high speed, heavy loads and transportation of abrasive substances, like sand, salt, sugar, and many other applications.

The stainless steel pins guarantee a higher working load and due to the new pin retention with grub screw, the assembly of this belt is 100% secure.

The robust structure of **Zero Contact™ PRO** can be summarized in minimal maintenance, long life expectation and high reliability.

Zero Contact™ PRO is a versatile belt, allowing a wider range of available widths and radii. Find out also our “two-tracks” version.



Extreme speed



Heavy duty



High abrasion resistance



Movex
OFFICIAL UK PARTNER

Oadby Conveyors

Oadby Conveyors
68 Scudamore Road
Braunstone Frith Ind. Est.
Leicester
LE3 1UA

0116 232 4848
convteam@oadbyplastics.co.uk

Head Office

Oadby Plastics Ltd
68 Scudamore Road
Braunstone Frith Ind. Est.
Leicester
LE3 1UA

0116 232 1010
sales@oadbyplastics.co.uk

For further information and specification details please visit our comprehensive website. Due to a policy of continual product development, Oadby Conveyors reserves the right to alter any of the specifications given in the publication without prior notice. The specification must be checked with Oadby Conveyors prior to manufacture. For this reason no responsibility or liability for accuracy is accepted by Oadby Conveyors.

Company registration No. 03542957 | www.oadbyconveyors.co.uk



Certificate Number 8147
ISO 9001, ISO 14001